

**INVERELL SHIRE COUNCIL**

**NOTICE OF MEETING**

**ECONOMIC & COMMUNITY SUSTAINABILITY COMMITTEE**

8 June, 2017

An Economic & Community Sustainability Committee Meeting will be held in the Committee Room, Administrative Centre, 144 Otho Street, Inverell on Wednesday, 14 June, 2017, commencing at the conclusion of the Joint Sitting of the Committees.

Your attendance at this Economic & Community Sustainability Committee Meeting would be appreciated.

**P J HENRY PSM**

**GENERAL MANAGER**

---

---

**A G E N D A**

---

---

<b>SECTION A</b>	<b>APOLOGIES CONFIRMATION OF MINUTES DISCLOSURE OF CONFLICT OF INTERESTS/PECUNIARY AND NON-PECUNIARY INTERESTS BUSINESS ARISING FROM PREVIOUS MINUTES</b>
<b>SECTION B</b>	<b>ADVOCACY REPORTS</b>
<b>SECTION C</b>	<b>COMMITTEE REPORTS</b>
<b>SECTION D</b>	<b>DESTINATION REPORTS</b>
<b>SECTION E</b>	<b>INFORMATION REPORTS</b>
<b>SECTION F</b>	<b>GENERAL BUSINESS</b>
<b>SECTION H</b>	<b>GOVERNANCE REPORTS</b>
<b>SECTION G</b>	<b>CONFIDENTIAL MATTERS (COMMITTEE-OF-THE-WHOLE)</b>

---

## Quick Reference Guide

*Below is a legend that is common between the:*

- Inverell Shire Council Strategic Plan;
- Inverell Shire Council Delivery Plan; and
- Inverell Shire Council Operational Plan.



MINUTES OF THE ECONOMIC & COMMUNITY SUSTAINABILITY COMMITTEE MEETING HELD IN THE COMMITTEE ROOM, INVERELL SHIRE COUNCIL, 144 OTHO STREET, INVERELL ON WEDNESDAY, 10 MAY 2017, COMMENCING AT 10.30AM.

PRESENT: Cr J A Watts (Chairperson), Crs P J Harmon, P A King, A A Michael and C M Dight.

Also in attendance: Crs D F Baker, S J Berryman and J N McCosker.

Paul Henry (General Manager), Brett McInnes (Director Civil and Environmental Services) and Sharon Stafford (Executive Assistant).

SECTION A

APOLOGIES:

There were no apologies received.

1. CONFIRMATION OF MINUTES

*RESOLVED (Michael/Harmon) that the Minutes of the Economic and Community Sustainability Committee Meeting held on 12 April, 2017 as circulated to members, be confirmed as a true and correct record of that meeting.*

2. DISCLOSURE OF CONFLICT OF INTERESTS/PECUNIARY AND NON-PECUNIARY INTERESTS

There were no interests declared.

3. BUSINESS ARISING FROM PREVIOUS MINUTES

Nil.

SECTION B  
ADVOCACY REPORTS

Cr King Inverell Junior Soccer

Cr King praised the Inverell Junior Soccer Committee on conducting a well run junior winter competition. It was noted that registrations for the competition this year have increase by approximately 30 per cent and the fields are in great shape following the recent rain.

Cr Dight ALGWA NSW Annual Conference

Cr Dight noted the Council was well represented at the Australian Local Government Women's Association NSW Conference held in Penrith from 4-6 May, 2017.

A report will be prepared by the delegates for consideration at the May Ordinary Meeting.

Cr Harmon Blair Athol Day Spa

Cr Harmon advised that he attended the official opening of the Blair Athol Day Spa on Saturday, 6 May, 2017. Cr Harmon congratulated Kim and Pauline on delivering a quality project and hopes the Day Spa is well supported.

Cr Harmon      Inverell Hospital Redevelopment

Cr Harmon advised that both he and the General Manager met with Health Infrastructure NSW Senior Director and Project Manager for the redevelopment of the Inverell Hospital on Thursday, 4 May, 2017. An update on the project was provided, noting that the final business case is still subject to funding, as part of the normal budget planning cycle.

Cr Harmon      North East Library Zone Meeting

Cr Harmon noted that he is looking forward to welcoming delegates to the Library Zone meeting being held at the Inverell Library on Thursday 11 May, 2017.

Cr Michael      Events in Inverell

Cr Michael noted that the Inverell Golf Club will be hosting a Veterans Golf Carnival this weekend.

Cr Michael also noted that the Grafton to Inverell Cycle Race will be held this Saturday.

SECTION D  
DESTINATION REPORTS

MIPR-A      1.      REQUEST FOR SPONSORSHIP – INVERELL PARKRUN      S12.22.1/10

*RESOLVED (Harmon/Dight) that the Committee recommend to Council that:*

- i)      The course proposed by the Parkrun committee be approved as the “Inverell Parkrun Course”;*
- ii)      A sum of \$2,500 be provided from Council’s community health initiatives budget to support the establishment costs of this new activity; and*
- iii)      Council discuss ownership of the equipment with the Parkrun Committee.*

CSO-T      2.      REQUEST FOR SPONSORSHIP – BHAWAA MIYAAY ABORIGINAL WOMEN’S RUGBY LEAGUE TEAM      S12.22.1/10

*RESOLVED (Michael/Harmon) that Ms Edwards be advised that that Council is unable to support this initiative.*

MDS-A      3.      GRAMAN RESERVE – DEVELOPMENT OPPORTUNITY      S15.8.2

*RESOLVED (Michael/Dight) that the Committee recommend to Council that:*

- i)      The development opportunity be referred to the Graman Hall Committee seeking their comments prior to further consideration; and*
- ii)      Further clarification from the Sapphire City Motor Sports Club be sought on the intended use of the proposed facility.*

SECTION E  
INFORMATION REPORTS

1.      FIRE AND EMERGENCY SERVICE LEVY (FESL)      S12.13.1

*RESOLVED (Michael/Dight) that the items contained in the Information Reports to the Economic & Community Sustainability Committee Meeting held on Wednesday, 10 May, 2017, be received and noted.*

GM-A FIRE & RESCUE NSW INVERELL

Concerns were raised in respect of the full time retained Fire & Rescue Station Officer position for Inverell.

*RESOLVED (Michael/Harmon) that the Committee recommend to Council that the Fire & Rescue Commissioner be requested to provide Council with an update in respect of future plans for the full time retained Station Officer position for Inverell.*

SECTION F  
QUESTIONS WITHOUT NOTICE

GM-A  
MCS-A

Cr Dight Bonshaw

Cr Dight provided the General Manager with a 'wish list' of matters to be considered for the village of Bonshaw.

The General Manager advised that he will bring the list of matters to the attention of Council, identifying whether outcomes can be achieved through existing maintenance notes or whether they are future delivery plan items.

Cr King also asked if the bitumen footpath along Texas Street, adjacent to the school, could be inspected and possibly repaired under the existing maintenance vote.

Cr Berryman Boundary Adjustment

Cr Berryman requested an update on the boundary adjustment issue between Inverell Shire Council and Armidale Regional Council.

The General Manager advised that Council has written to the Administrator of Armidale Regional Council requesting that he consider the requests from landowners in the Georges Creek / New Valley area to also be transferred to Inverell Shire Council.

A response has not been received to date in respect of this matter.

DCES-N Cr McCosker Orchard Place

Cr McCosker sought clarification in respect of the resolution adopted by Council at the April Ordinary Meeting. The Director Civil and Environmental Services advised that as per Res 27/17, Council will continue to monitor the level of service provided to road users on Orchard Place. The application of a dust suppressant will also be investigated and a report will be brought back to the Civil and Environmental Services Committee for consideration.

Cr Baker Special Rate Variation

Cr Baker requested an update on progress with Council's application for a Special Rate Variation. The General Manager advised that he received confirmation from IPART on Tuesday, 9 May, 2017 that Council's application had been approved in full.

SECTION H  
GOVERNANCE REPORTS

MFS-N 1. MONTHLY INVESTMENT REPORT S12.12.2/09

*RESOLVED (Michael/King) that:*

- i) The report indicating Council's Fund Management position be received and noted; and*
- ii) The certification of the Responsible Accounting Officer be noted.*

DCS-N  
MFS-N

2. QUARTERLY BUDGET AND OPERATIONAL PLAN REVIEW 2016/2017  
S12.5.1

*RESOLVED (Harmon/Dight) that:*

- i) Council's Quarterly Operational Plan and Budget Review for 31 March, 2017 be adopted; and*
- ii) The proposed variations to budget votes for the 2016/2017 financial year be adopted, providing an estimated cash surplus at 30 June, 2017 from operations of \$2,723.*

There being no further business, the meeting closed at 11.20am.

CR J A WATTS

CHAIRPERSON

# ECONOMIC & COMMUNITY SUSTAINABILITY COMMITTEE MEETING

Wednesday, 14 June, 2017

---

## Table of Contents

### SECTION/PAGE

Boundary Adjustment - Armidale Regional Council	D	5
Budget and Operational Plan Review 2016/2017	H	1
Disability Inclusion Action Plan Update	D	2
Expiring Licence Agreements	D	7
Monthly Investment Report	H	5
Opera in the Paddock 2017	E	1
Public Libraries NSW North East Zone Meeting	D	3
Request for Assistance – Eat Drink Live New England	D	1

TO ECONOMIC & COMMUNITY SUSTAINABILITY COMMITTEE MEETING 14/6/2017

<b>ITEM NO:</b>	1.	<b>FILE NO:</b> S12.22.1/10
<b>DESTINATION 2:</b>	A community that is healthy, educated and sustainable	<b>C</b>
<b>SUBJECT:</b>	<b>REQUEST FOR ASSISTANCE – EAT DRINK LIVE NEW ENGLAND</b>	
<b>PREPARED BY:</b>	Fiona Adams, Manager Integrated Planning & Reporting	

**SUMMARY:**

Council has received a request from Sean Taylor, Event Manager of Eat Drink Live New England, asking Council for assistance with their event to be held Saturday, 11 November, 2017.

**COMMENTARY:**

Councillors may be aware that Eat Drink Live is now in its third year, and is an event which showcases the region's produce and producers. It is hosted by a volunteer committee and funds raised from the event are returned to the maintenance and facilities of The Inverell Club.

The event consists of a street market of regional fare and wares, a degustation dinner and information sessions. Last year's event attracted visitors from as far as Brisbane and targets the growing culinary tourism industry.

In 2017, the event will expand, with a wine and canapés evening on Friday 10 November and include a 25 per cent increase in stallholders, taking the total number of stalls to 65.

In his letter (Appendix 1, D11-D12) Mr Taylor states the ability to increase participation would be greatly assisted by securing a celebrity chef to headline the program. As a result, he proposes Council contributes 50% of the fee for a celebrity chef – an amount of \$4,000.

In return, organisers would provide a variety of promotional opportunities for Council, including web, print, social media and verbal acknowledgement.

**RELATIONSHIP TO STRATEGIC PLAN, DELIVERY PLAN AND OPERATIONAL PLAN:**

**Strategy:** S.03 Council provides equitable services, consistent with available resources and priorities to meet the Shire's identified needs and preferences.

**Term Achievement:** S.03.01 Services and programs that Council provides are determined based on equity, customer requirements and community benefits, best value and excellence.

**Operational Objective:** S.03.01.01 Appropriate services and programs are selected based on considerations of equity, best value, relevance and benefit to the community.

**POLICY IMPLICATIONS:**

Management Policy: Donation Policy – 'The purpose of providing Donations from public funds is to help promote or assist individuals or organisations for which there is a recognised public benefit, Generally the maximum donation provided will be \$200.00.'

**CHIEF FINANCIAL OFFICER'S COMMENT:**



Nil.

**LEGAL IMPLICATIONS:**

Nil.

**RECOMMENDATION:**

*A matter for the Committee.*

<b>ITEM NO:</b>	2.	<b>FILE NO:</b> S3.16.4
<b>DESTINATION 2:</b>	A community that is healthy, educated and sustainable	<b>C</b>
<b>SUBJECT:</b>	<b>DISABILITY INCLUSION ACTION PLAN UPDATE</b>	
<b>PREPARED BY:</b>	Stephen Golding, Executive Manager Corporate and Community Services	

**SUMMARY:**

In accordance with the *NSW Disability Inclusion Act 2014 (DIA)* Local Government is required to undertake disability inclusion action planning by 1 July, 2017. Council considered the Plan at their April Ordinary meeting and subsequently resolved, as part of the consultation and community engagement process, to place the Plan on public exhibition. The exhibition period closed 2 June, 2017.

**COMMENTARY:**

As part of the community engagement and consultation process, Council's Draft Disability Inclusion Action Plan (DIAP) was placed on public exhibition on Friday, 28 April, 2017 until the close of business on Friday, 2 June, 2017. Notification of the public exhibition was through Council's websites, Facebook and the Inverell Times.

The Draft Inclusion (Disability) Action Plan was available to be viewed at the Council Administration Office and Inverell Library over the exhibition period. Copies of the Draft Inclusion (Disability) Action Plan and supporting documents were also available for download from Council's website [www.inverell.nsw.gov.au](http://www.inverell.nsw.gov.au). Written submissions were able to be lodged to Council's postal address, via the [www.myinverellmysay.com.au](http://www.myinverellmysay.com.au) website or emailed to [yoursay@inverell.nsw.gov.au](mailto:yoursay@inverell.nsw.gov.au).

At the close of the exhibition period, no submissions had been received on the Draft Plan. Council is now being asked to adopt the Draft Inclusion Disability Action Plan (DIAP).

**RELATIONSHIP TO STRATEGIC PLAN, DELIVERY PLAN AND OPERATIONAL PLAN:**

**Strategy:** C.15 The social well being and health of individuals and communities within the Shire is being maintained and improved.

**Term Achievement:** C.15.01 Strategies are in place to respond to the social and health needs of the community.

**Operational Objective:** C.15.01.01 Actively participate in the formulation, management and implementation of the Shire's Social Plan.

**POLICY IMPLICATIONS:**

The *DIA Act 2014* states that 'a local council must, as soon as practicable after preparing its annual report, give the Minister a copy of the part of the annual report relating to council's report on implementation of its disability inclusion action plan.

**CHIEF FINANCIAL OFFICER'S COMMENT:**

Nil.

**LEGAL IMPLICATIONS:**

Council is mandated by the *DIA Act 2014* to have a plan setting out the measures it intends to include so that people with a disability can access general supports and services available in the community and participate fully and report to the Minister on the implementation.

**RECOMMENDATION:**

*That the Committee recommend to Council that the Inclusion Disability Action Plan be adopted.*

<b>ITEM NO:</b>	3.	<b>FILE NO:</b> S3.6.4
<b>DESTINATION 1:</b>	A recognised leader in a broader context	<b>R</b>
<b>SUBJECT:</b>	<b>PUBLIC LIBRARIES NSW NORTH EAST ZONE MEETING</b>	
<b>PREPARED BY:</b>	Cr Di Baker and Sonya Lange, Manager Library Services	

**SUMMARY:**

The Public Libraries NSW North East Library Zone ordinary meeting was held at Inverell Shire's Library on 11 May, 2017.

**COMMENTARY:**

Mayor Paul Harmon welcomed Council delegates and Library Managers from the zone. Cr Di Baker and Manager Library Services, Sonya Lange were in attendance. Four people attended remotely via "BlueJeans", a software solution providing a real time audio / video connection. Mr Craig Maynard, a member of the deaf community who tutors Auslan (sign language) in the Inverell library, provided a short presentation. Mr Maynard's introduction was signed by Sonya Lange for the meeting to show how beneficial it is to learn and use sign language. The meeting was chaired by Mr Bill Hazlet, Walcha. Apologies were accepted and the minutes confirmed.

The State Library report was presented by Ellen Forsyth. It included:

- The highly successful NSW Government's Ageing Strategy program, 'Tech Savvy Seniors', will continue over the next 4 years;

- Collect, Connect, Community: an introduction to the State Library for public library staff was a very positive programme;
- Modular and prefabricated library design project has been contracted to FJMT studio. The project will produce concept plans for libraries 190-1000 square metres;
- Early literacy, LIAC and Drug info services, and Indigenous Services continue to progress programs for public libraries;
- Ongoing technological advances include Digital Practice Guidelines, NSW.net Services, State-wide eResources with a Toolkit and Training, Consortia Opt-in Database and Trials, Internet Connectivity, Digital Frontiers Seminars, Firewall upgrades, WiFi Hotspots and NBN Services; and
- The State Library has secured \$15 million in private funding to establish new world-class public galleries and a premier learning space in the historic Mitchell Library.

The NSW Public Libraries Association (NSWPLA) update from Ms Lynne Makim, EO, noted that a Strategic Planning Day would be held soon. The Plan will be presented at a series of meetings with the NSWPLA membership. An Outreach Services Symposium on 21 November will highlight the many great programmes and projects being undertaken in our libraries.

Each Library Service gave a report on their activities. Iluka Library is under threat of closure. Narrabri Library and TAFE have collaborated to offer industry related learning.

The 2019 annual conference is to be held in Coffs Harbour. Discussions around the venues available, which eliminate most of the zone because of the requirements for an airport and one site venue, were held.

The practicalities of holding zone meetings around the zone or in a central location and the use of "BlueJean" communications was discussed. Clarification on the voting rights of committee members attending via "BlueJean" technology was discussed and has to be ascertained. The next zone meeting will be a "BlueJeans" trial.

#### **RELATIONSHIP TO STRATEGIC PLAN, DELIVERY PLAN AND OPERATIONAL PLAN:**

**Strategy:** R.08 Council leads the community by influencing and participating in policy development to the benefit of the Shire through partnerships and alliances with government, regional interests, shire groups and communities.

**Term Achievement:** R.08.01 A targeted program of advocacy and policy discussion is being conducted with the active cooperation of others benefiting interests around social, environmental, economic and infrastructure priorities.

**Operational Objective:** R.08.01.01 To facilitate intergovernmental relations to ensure maximum cooperation between the Council and the Federal and State Governments to achieve the optimum support for the Inverell Shire.

#### **POLICY IMPLICATIONS:**

Nil.

#### **CHIEF FINANCIAL OFFICER'S COMMENT:**

Nil.

#### **LEGAL IMPLICATIONS:**

Nil.

<b>RECOMMENDATION:</b>
------------------------

*That the Committee recommend to Council that:*

- i) The information be received and noted; and*
- ii) That Council support any recommendations by the Public Libraries Association executive to enable voting rights of members attending meetings remotely via technology.*

<b>ITEM NO:</b>	4.	<b>FILE NO:</b> S13.1.1
<b>DESTINATION 1:</b>	A recognised leader in a broader context	<b>R</b>
<b>SUBJECT:</b>	<b>BOUNDARY ADJUSTMENT - ARMIDALE REGIONAL COUNCIL</b>	
<b>PREPARED BY:</b>	Paul Henry, General Manager	

**SUMMARY:**

This report provides an update on the agreement with Armidale Regional Council regarding a boundary adjustment.

**COMMENTARY:**

Following the agreement reached with Armidale Regional Council on 8 February, 2017, the Office of Local Government has been advised of Council's resolution in this matter.

With the current financial year almost complete and the September elections fast approaching, advice was sought from the Office of Local Government on when the Minister would deal with this agreement. The advice was:

*'The boundary adjustment request is still being assessed by the Office of Local Government. Once this assessment is complete, the Office of Local Government will request the Land and Property Office to prepare the official map for the amended boundaries of the two (2) Councils. Once the map is completed the Office will lodge the Council resolutions/map with the Minister for Local Government for consideration.*

*A local government election will take place for Armidale Regional Council in September 2017. It must be noted that a boundary adjustment can not occur immediately prior to a local government election. During this time though, the boundary adjustment request will continue to be processed'.*

It is suggested that the Member for Northern Tablelands, Mr Adam Marshall, be requested to enquire of the Minister's office on a timeframe for dealing with the boundary adjustment.

The outstanding matter of the eight (8) property owners in the locale to the south east of 'Green Valley', that also seek to be part of Inverell Shire Council, received some clarity recently.

The Armidale Regional Council Administrator, Dr Tiley, advised that he intends to take no action on the requests from these ratepayers. He further indicated that the matter may be referred to the 'New Council' elected at the September Council elections, if Inverell Shire wants the matter pursued.

Correspondence from two (2) of the property owners in the 'south eastern' area has indicated that Dr Tiley's decision had not been communicated to the property owners who requested that they be included in any boundary adjustment.

It is suggested:

- a) That Inverell Shire Council inform the eight (8) property owners of the position taken by the Administrator;
- b) Council advise the property owners that Inverell Shire will pursue their stated intention with the 'new' Armidale Regional Council following the September Local Government elections; and
- c) That Inverell Shire Council prepares a submission to the Armidale Regional Council, seeking an expansion of the area to be transferred to Inverell Shire Council to cover the eight (8) properties. Further that this submission be presented to Armidale Regional Council in October, 2017, after their local government election.

**RELATIONSHIP TO STRATEGIC PLAN, DELIVERY PLAN AND OPERATIONAL PLAN:**

**Strategy:** R.08 Council leads the community by influencing and participating in policy development to the benefit of the Shire through partnerships and alliances with government, regional interests, shire groups and communities.

**Term Achievement:** R.08.01 A targeted program of advocacy and policy discussion is being conducted with the active cooperation of others benefiting interests around social, environmental, economic and infrastructure priorities.

**Operational Objective:** R.08.01.01 To facilitate intergovernmental relations to ensure maximum cooperation between the Council and the Federal and State Governments to achieve the optimum support for the Inverell Shire

**POLICY IMPLICATIONS:**

Nil.

**CHIEF FINANCIAL OFFICER'S COMMENT:**

Nil.

**LEGAL IMPLICATIONS:**

Nil.

**RECOMMENDATION:**

*A matter for the Committee.*

<b>ITEM NO:</b>	5.	<b>FILE NO:</b> S4.11.9
<b>DESTINATION 5:</b>	The communities are served by sustainable services and infrastructure.	<b>S</b>
<b>SUBJECT:</b>	<b>EXPIRING LICENCE AGREEMENTS</b>	
<b>PREPARED BY:</b>	Alice Holton, Corporate Support Officer - Telephonist	

**SUMMARY:**

The Committee is advised of four (4) Licence Agreements that are due to expire shortly. The Committee is requested to consider the licence holders for new agreements.

**COMMENTARY:**

The listed Licence Agreements below have been audited for compliance of licence conditions and payment of associated fees.

All have been found to be compliant to the required conditions and to meeting Council's expectation of maintaining the quality of Council land.

It is noted that the licences are issued subject to the licensee providing Public Liability Insurance for \$10M. These Policies now cost over \$500 p.a.

The Committee is asked to consider the following licence holders to be offered new agreements, under the same terms and conditions:

5.10.61	Transgrid	01/07/17 - 30/06/20
5.10.137	Mr Colin Moore	01/07/17 - 30/06/19
5.10.132	Tharawonga Mobile Resource Unit	01/08/17 – 31/07/18
5.10.130	New England Toyota	02/06/17 – 01/06/18

**1. Transmitting Station, Transgrid – Lot 22, DP 721168, Mandoe Radio Site, Atholwood**

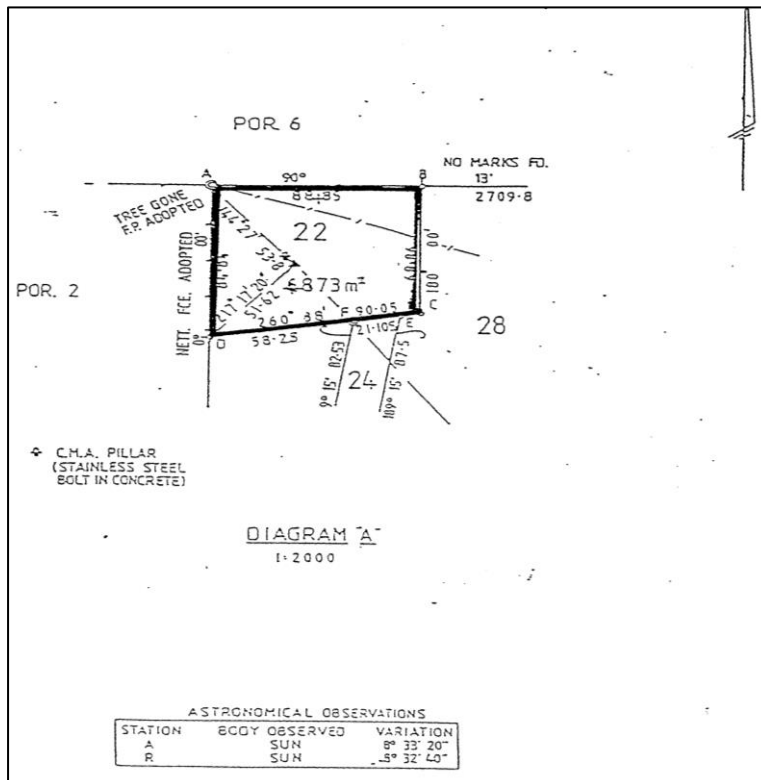

The authorised use of the land is for the purpose of a transmitting station. Public Liability insurance is required to the amount of \$10M.

An inspection of the area confirms use is in accordance with the Licence Agreement.

Last amount billed \$1100.00 (GST inclusive).



**RECOMMENDATION:**

*That the Committee recommend to Council that:*

- iii) *Council renew the agreement with Transgrid, Lot 22, DP 721168, Mandoe Radio Site, Atholwood for a three (3) year period with a further three (3) year option under the same terms and conditions;*
- iv) *the licence fee be \$1100.00 per annum (GST Inclusive); and*
- v) *the Licence Agreement be subject to any other terms and conditions as negotiated by Council's General Manager.*

2. Licence Agreement, Mr Colin Moore – Part Unformed Laneway Adjacent to Lot 1, DP 161692 and Lot 5, Sec 8, DP 448428, Inverell.



The authorised use of the land is for the purpose of maintaining the vegetation on the parcel of land and incorporating this land as an extension of Mr Moore's yard area. Public Liability insurance is required to the amount of \$10M.

An inspection of the area confirms use is in accordance with the Licence Agreement.

Last amount billed \$206.00 (GST inclusive).

**RECOMMENDATION:**

*That the Committee recommend to Council that:*

- i) Council renew the agreement with Mr Colin Moore for Part Unformed Laneways

*Adjacent to Lot 1, DP 161692 and Lot 5, Sec 8, DP 448428, Inverell for a two (2) year period with a further two (2) year option under the same terms and conditions;*

- ii) the licence fee be \$212.18 per annum (GST inclusive) with a 3% increase per annum; and*
- iii) the Licence Agreement be subject to any other terms and conditions as negotiated by Council's General Manager.*

**3. Licence Agreement, Tharawonga Mobile Resource Unit – Yetman Recreation Hall, Yetman.**

The authorised use of the hall is for the purpose of hosting preschool activities. Public Liability insurance is required to the amount of \$10M.

An inspection of the area confirms use is in accordance with the Licence Agreement.

Last amount billed \$233.40 (GST inclusive).

**RECOMMENDATION:**

*That the Committee recommend to Council that:*

- i) Council renew the agreement with Tharawonga Mobile Resource Unit for Yetman Recreation Hall for a one (1) year period with a further one (1) year option under the same terms and conditions;*
- ii) the licence fee be \$240.40 per annum (GST inclusive); and*
- iii) the Licence Agreement be subject to any other terms and conditions as negotiated by Council's General Manager.*

**4. Licence Agreement, J.R & B.A Thompson Pty Ltd T/A New England Toyota – Lot 2, DP 1038122 Oliver Street, Inverell.**

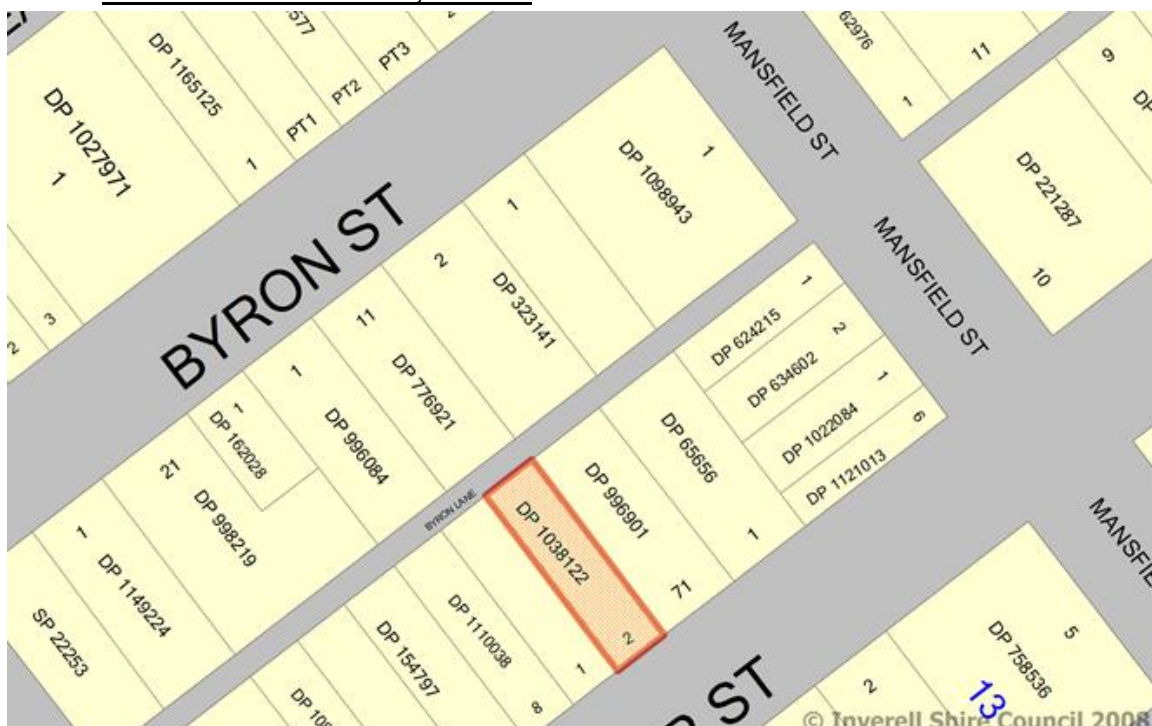



The authorised use of the land is for the purpose of carparking associated with a commercial car yard. Public Liability insurance is required to the amount of \$10M.

An inspection of the area confirms use is in accordance with the Licence Agreement.

Last amount billed \$200.00 per month (GST inclusive).

**RECOMMENDATION:**

*That the Committee recommend to Council that:*

- i) Council renew the agreement with New England Toyota for Lot 2, DP 1038122, Oliver Street, Inverell for a one (1) year period with a further one (1) year option under the same terms and conditions;*
- ii) the licence fee be \$220.00 per month (GST inclusive); and*
- iii) the Licence Agreement be subject to any other terms and conditions as negotiated by Council's General Manager.*

**APPENDIX 1**

**EAT · DRINK**  
**NEW ENGLAND**



23 May 2017

Mr Paul Henry  
 General Manager  
 Inverell Shire Council  
 PO Box 138  
 INVERELL NSW 2360

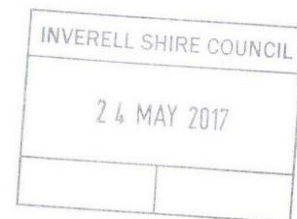

Dear Paul,

Re: Eat Drink New England 2017 – Financial support

We are in the early stages of organizing this year's event. It will be held on Saturday 11<sup>th</sup> November 2017. We are looking to highlight local & regional produce and products through a market style event. This will involve around 65 Stall holders. If we can achieve this number, it will represent an increase of approximately 25% on last year's attendees. Our previous two events have attracted people from all over the region and beyond. As an example, last year we had a group of six motorcycle riders from Brisbane and Sydney specifically attend the event. We had just under two thousand people attend over the period of the day.

This year's event will again include a Regional Degustation Dinner. This dinner, held on Saturday evening, has sold out the last two years. Last year's dinner was sponsored by TAFE New England. Their Certificate 3 Hospitality students supplied, cooked and presented the dinner with the assistance of three TAFE Chefs. TAFE New England have verbally agreed to sponsor the dinner this year.

An addition to this year's event will be a Wine tasting and Canapes evening featuring Regional food and wine. This will be held on the Friday evening.

After recently attending 'Taste of Tamworth', 'Seasons of Uralla' and 'Moree on a Plate' it has become evident to increase public attendance we need to have a Celebrity Chef of some profile. While still in negotiation it appears, the cost will be in the order of \$8000. Our overall budget for the event is \$18,000.

I am writing to Inverell Council seeking financial support of \$4000 to meet half the cost of obtaining a Celebrity Chef. We would be happy to provide the Council with the following exposure;

- Logo placement on all printed advertising (except Street banner) including A3 posters, Media advertising. Back page Logo placement on free handout booklet – 400 printed.
- Mention in any editorials done during marketing period.
- Logo placement on 'Programmes' page in free handout booklet– 400 printed.
- Advertisement in Monthly Inverell Club Newsletter (Email)

P: (02) 6722 3043

E: INVERELLCLUB@GMAIL.COM

THE INVERELL CLUB LTD

CNR EVANS & CAMPBELL STS  
 PO BOX 330  
 INVERELL NSW 2360



- On stage advertising in main auditorium (you to supply).
- Banner or teardrop advertising in front yard of Inverell Club (you to supply).
- Logo advertising of Facebook page.

The Inverell Club Ltd is a not for profit organization with all profits being spent on improving our historic Club building and facilities. We currently have the only working squash court in Inverell.

This event hopes to improve the publics knowledge as to what is produced and grown in the local and regional area with mind to make these economies stronger.

We hope you look favourable on our request and would be happy to make a presentation to Council or provide further information if required.

Yours Faithfully,

Sean Taylor (0409 666 854)  
Chairperson  
Eat Drink New England 2017

P: (02) 6722 3043

E: INVERELLCLUB@GMAIL.COM

THE INVERELL CLUB LTD

CNR EVANS & CAMPBELL STS  
PO BOX 330  
INVERELL NSW 2360

**TO ECONOMIC & COMMUNITY SUSTAINABILITY COMMITTEE MEETING 14/6/2017**

<b>ITEM NO:</b>	1.	<b>FILE NO:</b> S26.3.14
<b>DESTINATION 2:</b>	A community that is healthy, educated and sustainable	<b>C</b>
<b>SUBJECT:</b>	<b>OPERA IN THE Paddock 2017</b>	
<b>PREPARED BY:</b>	Paul Henry, General Manager	

**SUMMARY:**

Council is in receipt of correspondence from Peta Blyth OAM, Artistic Director, Opera North West Ltd regarding Opera in the Paddock which was held on 25 March, 2017. Council is being asked to receive and note the information provided.

**COMMENTARY:**

Opera in the Paddock was held on the property 'Mimosa' on 25 March, 2017 and according to Mrs Blyth, *'both Opera in the Paddock performances were extremely well received and artistically most successful'*.

As Councillors would be aware, two (2) concerts were held this year. The event held in Armidale on 24 March, 2017, attracted an audience of 268 people, and then the paddock event the following evening attracted an audience of 576. It was generally accepted that the numbers at Mimosa were affected by the major floods and rain events both prior to and following the event. Rain records show that the area had the largest rain fall for March in living memory.

Mrs Blyth has provided Council with a comprehensive report on the event. A copy is attached as Appendix 1 (E2-E19) for the information of Council.

**RECOMMENDATION:**

*That the items contained in the Information Reports to the Economic & Community Sustainability Committee Meeting held on Wednesday, 14 June, 2017, be received and noted.*

## APPENDIX 1

# *Opera in the Paddock*

## 2017



Soloists, conductor Tim Sexton and the Mimosa Orchestra

*Lazenby Hall UNE, March 24, 2017*  
*"Mimosa" Inverell, March 25, 2017*



### THE PERFORMANCES

Both Opera in the Paddock performances were extremely well received and artistically most successful. The three young rising stars were triumphant, very popular with the audiences also All three, Jeremy Kleeman, Panayiota Kalatzis and Eleanor Greenwood gained greatly from the professional experience and exposure. These emerging artists are working nationally and internationally. Their performances were balanced by the humour and of charisma of 'paddock' favourite Scottish tenor, David Hamilton and Opera North West's Artistic Director, Peta Blyth.

Conductor and compere Tim Sexton once again brought together the Mimosa Orchestra in an incredibly short time and compered the performance with wit and good humour in his own inimitable style.

Armidale audiences were treated to the added delight with the involvement of twenty young singers from NECOM Children's Choirs. The young singers enjoyed greatly being involved in the performance.

Masterclasses and lessons conducted by visiting artists play an integral part of Opera North West's charter. Supported by Armidale Regional Council, these took place in Armidale Wednesday 22nd March before commencement of rehearsals. An important part of ONW's charter, these masterclasses maximize the wealth of talent and expertise that the Opera in the Paddock performance brings to the region.

Disappointingly, given the expenditure on marketing and the overall event, numbers in both venues were lower. It was generally accepted that the numbers at Mimosa were affected by the major floods and rain events both prior to and following the event. Rain records show that the area had the largest rain fall for March in living memory. Thankfully, the weather at Mimosa was superb with a most pleasant, ideal temperature.

### BENEFITS OF THE PROJECT

#### COMMUNITY ENGAGEMENT AND CAPACITY BUILDING

ONW is committed to nurturing the cultural development of regional artists, providing them with the infrastructure under which they can perform professionally - a concept that is unique to the area. ONW is equally committed to the development of young and emerging local performers and the masterclasses give to these young performers a rare opportunity to hone their skills with those in the profession.

ONW relies on the consistent and invaluable contribution of large numbers of volunteers from a broad community base to run its annual program and are essential to the smooth running of the events. These include program sellers at both locations, Inverell VRA, TAFE film and TV students, floral art expert and TAFE hospitality students.

A loyal group of supporters, 'Friends of Paddock Opera' continue to be avid supporters of the event, strengthening community engagement and ownership of the company, as well as providing practical assistance with mailouts and word of mouth promotion.

### **DESTINATION NSW**

The assistance provided through DESTINATION NSW to employ personnel for marketing and promotion is of great benefit to the event and also to the general promotion of the area. DESTINATION NSW enabled the following:

- employment of marketing personnel
- DESTINATION NSW's valuable network
- global recognition of the 'Opera In the Paddock' through the DESTINATION NSW Website - EVENTS
- assistance, advice and expertise

### **EMPLOYMENT OF ARTISTS AND CULTURAL WORKERS**



ONW is committed to providing opportunities to regional performers, volunteers and key stakeholders.

One of the benefits that the event brings to the community is the opportunity to provide:

- Employment
- Professional development

Networking opportunities i.e. regional musicians with metropolitan performers and conductor is an aspect that is highly valued by the musicians; each looking forward working together collaboratively. Over this time, ONW has built a core of highly talented and skilled members that form the Mimosa Orchestra, regionally based and supplemented by metropolitan musicians. In the 2017 performances, 22 players benefited from the two performances

For over a decade, ONW has offered paid employment opportunities to a range of local artists and cultural practitioners. This has included paying:

- singers
- conductors
- musicians



- part-time Administrative Assistant
- part-time Marketing Manager
- part-time Development Manager

The capacity to offer employment is significant as the availability of paid employment for artists in remote regional areas is often difficult, if not impossible, to secure.

#### **The Perfect Evening at "Mimosa"**



#### **BENEFITS TO THE NORTH WEST & NEW ENGLAND REGION**

Opera in the Paddock has attracted approximately 16,000 people over the past decade. A considerable number of those attending travel to Inverell for the event, contributing to the positive economic development of the town and its sustainability. Many visitors are travelling to Inverell for the first time and visit other local attractions during their stay.

#### **ECONOMIC DEVELOPMENT**

Businesses that directly benefit as a result of the event include:

- accommodation providers (hotels, motels, caravan parks, B + Bs)
- food, clubs and hospitality outlets
- retail outlets, boutique shops
- coach companies
- VRA volunteers
- catering and party hire



## LEARNING POINTS, FUTURE DEVELOPMENT

- More use of social media early on, suggested dedicated local or marketing university student looking for professional experience.
- Increase the amount of created media and stories to share with media outlets.
- Utilise video on social media and website to create engagement with audiences.
- Suggest slightly different repertoire at performances to encourage people to attend both.
- Pricing differences between the two performance continues to be an issue with audiences, investigate how to value add the Mimosa performance.
- Continue to engage with local choirs.
- Event or PR stunt to launch (tractor down the main road of Inverell with Peta singing atop a-la Priscilla!)
- Consider some kind of animal or vehicle entry for singers at Mimosa event (similar to Handa Opera on Sydney Harbour, this could make a great PR opportunity for the final rehearsal and would allow media outlets to have something to broadcast prior to the event).

## MARKETING

Opera in the paddock utilised postcode data, demographic information and historical sales data from Try bookings, and the MHM culture segments to assist in the development of a targeted marketing campaign to promote the two performances of Opera in the Paddock

The primary geographic focus was the New England region along with Sydney, Brisbane and SE QLD with our key inter/intra-state audiences being a 4-5 hour drive away from Inverell / Armidale. The campaign also consisted of a targeted local and national PR strategy engaging both broadcast, press, and radio.

## ONLINE AND SOCIAL MEDIA

Following the announcement of Opera in the Paddock and the ticket sales date on November 2016, Opera in the Paddock worked at maintaining a presence online and through its social media properties on Facebook and Instagram.

The website was refreshed to focus more on the performances of Opera in the Paddock and less on the company history and other events for Opera North West.

Frequently asked questions about the entire experience of attending were answered on the website and the blog was utilized to connect with past audiences via email newsletter articles showcasing the singers and the overall experience of visiting the region.

During the event period the website received more than 3300 users visiting the site over 4,556 sessions. 72.30% of these were from new visitors.

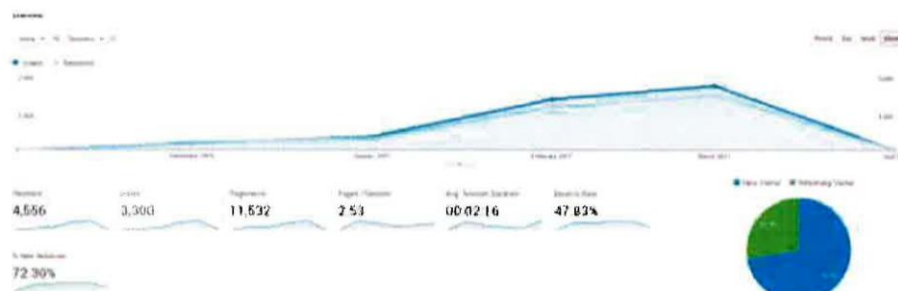

Opera in the Paddock began the marketing campaign with a direct mail database of approx. 1200 previous attendees, 491 valid email addresses, 660 Facebook followers, 101 Instagram followers

Over the marketing period, Opera in the Paddock had a 11.1% increase in Facebook followers resulting in 95,747 users reached, 5k total views for video and increases in engagement, page impressions and posts. We also increased the Instagram audience by 21%.

The email newsletter database increased to approx. 626 subscribers (16% increase) and consistently achieved above average open rates for the industry, some work could be done on increasing the click through rate.



- fuel outlets
- graphic designers
- printers
- electrical trades
- building material suppliers / builder
- insurance brokers
- tourism outlets

Current figures\* for the average overnight tourism spend for 2015 are as follows:

- Overnight \$140
- Day trip \$133

(\*National Visitor Survey (NVS) YE March 14, Tourism Australia (TRA))

#### **CULTURAL BENEFITS FOR THE COMMUNITY**

Opera in the Paddock provides the local community with the opportunity to participate in, as well as attend, a world class event. This is in turn:

- strengthens community wellbeing and spirit, creating a sense of place and belonging
- The identity of the event is firmly associated with Inverell now on a national level, especially in music circles
- engages young people in creating regional futures. Special child and student discounts aimed to encourage youth attendance.

#### **CULTURAL TOURISM**

The event has received national recognition in music circles and the publicity that the event attracts had continued to draw patrons from regional, interstate and metropolitan areas.

In so doing, alongside the economic benefits, the association promotes a positive cultural image for Inverell and surrounding regions.



## MARKETING and PROMOTION

### PROMOTION:

#### REGIONAL PRESS

Advertisements placed in the following regional papers:

Inverell Times, Border News, Moree Champion, Goondiwindi Argus, Glen Innes Examiner, Bingara Advocate, Wyallda Standard Armidale Express & Extra, Tenterfield Star, Northern Daily Leader & Country Leader, North West Magazine, Walcha News.

#### TELEVISION

Prime 7 & NBN - NBN across New England North West region + Newcastle & mid North coast  
Interviews and coverage conducted on Prime News prior to Armidale event. Main sponsors logos on final slide of TV advertisement

#### RADIO

Regional interviews & National **ABC FM** interview and 10 mins segment with presenter Martin Buzacott, 4MBSFM (magazine & radio, Brisbane 90 min interview, 2NZ, 2VM interview & Star FM interview.

#### REGIONAL MAGAZINES

Focus, New England Home and Living & Border Living

#### NATIONAL MAGAZINE

NRMA advertisement and article Jan/ Feb

#### DISTRIBUTION OF PROMOTIONAL MATERIAL

8000 flyers and brochures with sponsors logos are distributed across northern NSW and southern Queensland, as well metropolitan distribution in Brisbane and Sydney through relevant music venues. 200 posters are printed and displayed as above. Several direct mail outs to database of approximately 1000.

#### SOCIAL MEDIA \*

Much more emphasis was placed this year on social media reflective of the increasing awareness and importance the medium to publicize the events and create interest Facebook and Instagram.

**\* for detailed report see attached Marketing Report**

#### NEWSLETTER

Regular monthly newsletters updating patrons on event details, arrangements and information performances by artists.

#### WEBSITE

Regular updates on the Opera in the Paddock website; sponsors logos on sponsors page with link to sponsor's webpage.

#### CINEMA ADVERTISING

A new initiative - the TV advertisement ran for 3 months in the local cinema and Armidale cinema. The advertisement also displayed the main sponsors logos.

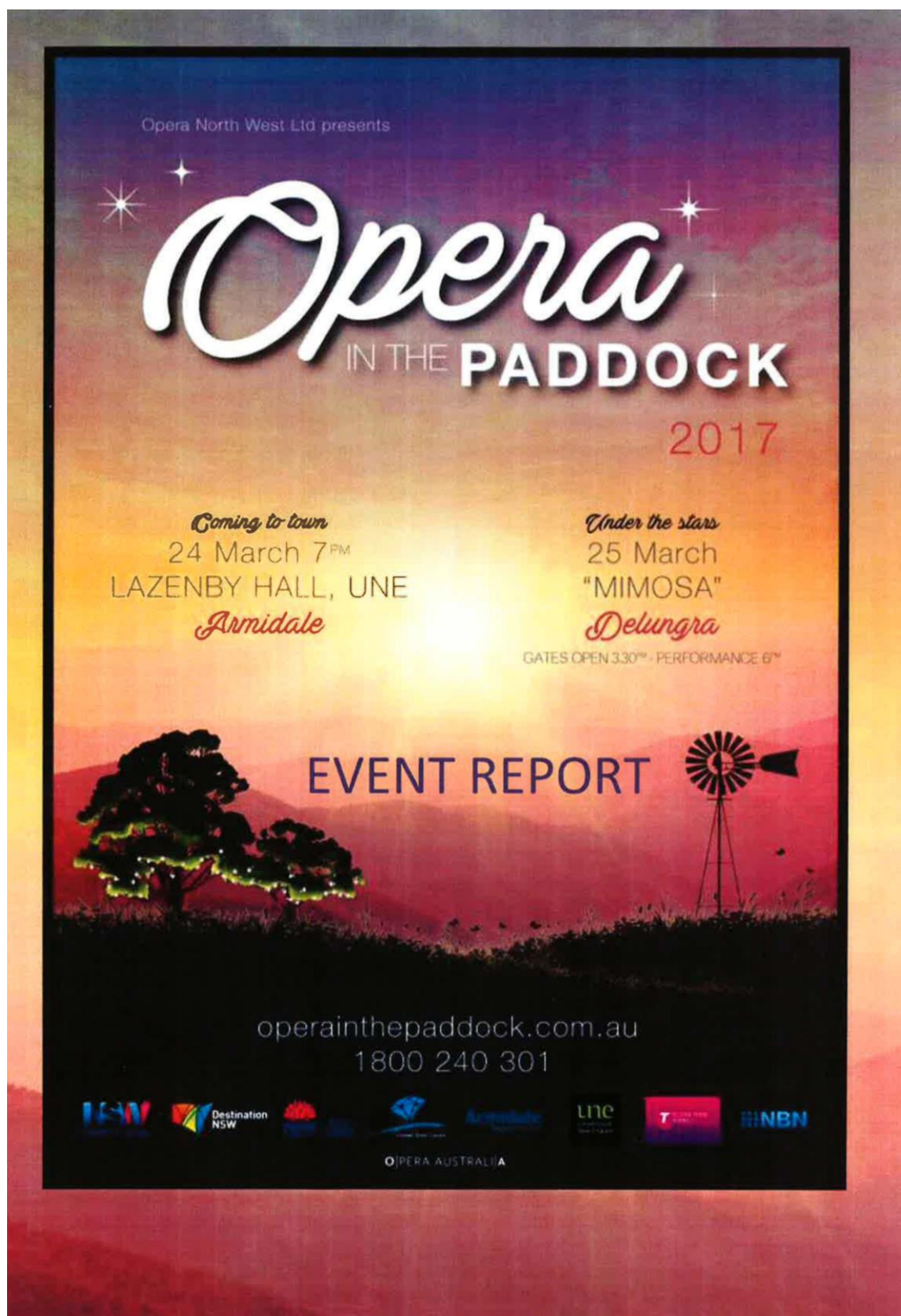

A poster for the 'Opera in the Paddock 2017' event. The background is a sunset or sunrise over a field, with a large tree on the left and a windmill on the right. The text is white and red. At the top, it says 'Opera North West Ltd presents'. The main title is 'Opera IN THE Paddock 2017'. Below this, it lists two events: 'Coming to town' on 24 March 7 PM at LAZENBY HALL, UNE, Armidale, and 'Under the stars' on 25 March 'MIMOSA' in Delungra. It also mentions 'GATES OPEN 3.30 PM - PERFORMANCE 6 PM'. The central text 'EVENT REPORT' is in a large, bold, sans-serif font. At the bottom, it provides the website 'operainthepaddock.com.au' and the phone number '1800 240 301'. There are several logos at the bottom, including NSW, Destination NSW, UNE, and others.

Opera North West Ltd presents

# Opera

IN THE Paddock

2017

*Coming to town*  
24 March 7 PM  
LAZENBY HALL, UNE  
*Armidale*

*Under the stars*  
25 March  
"MIMOSA"  
*Delungra*

GATES OPEN 3.30 PM - PERFORMANCE 6 PM

## EVENT REPORT

operainthepaddock.com.au  
1800 240 301

NSW Destination NSW UNE

OPERA AUSTRALIA

## Culture and music filled the region as Opera in the Paddock performed again for the 14<sup>th</sup> year in 2017

Opera in the Paddock is one of the major regional events and a highlight of the social calendar. Established in 2002, 2017 is the fourteenth year of Opera in the Paddock (OID) which continues to be a much-loved annual event within the New England community. Each year the performance attracts a core group of loyal supporters from the area and interested visitors.

Opera in the Paddock is held over two performance dates:

24 March 2017, in the auditorium, Lazenby Hall, UNE Armidale

25 March 2017, under the stars, 'Mimosa', Delungra (west of Inverell)

As part of this year's program, a series of vocal and instrumental masterclasses were offered and the local children's choir were also able to join in with the Armidale performance.

Opera in the Paddock is committed to providing regional audiences and artists with the opportunity to experience and perform with some of the best singers in Australia





## OPERA IN THE Paddock OBJECTIVES

To establish Opera in the Paddock as an event that gives visitors a unique experience of the New England area, so that people plan to visit the region to see it.

To profile Opera North West as one of the region's leading providers of high quality entertainment events with a focus on opera.

To profile Regional NSW Sydney as a destination for unique outdoor cultural events, making the most of its landscape, climate, infrastructure, culture and creative talent.

## KEY RESULTS

Crowds were good over both performances, though during the preceding weeks the region and state experienced heavy rainy periods

### Top sales via Postcode

Pcode	Tickets	%	Town	Region
2350	211	28.62%	Armidale	Our Region
2360	151	20.00%	Inverell	Our Region
2403	78	8.31%	Delungra	Our Region
2370	29	3.08%	Matheson	Our Region
2450	27	2.15%	Karangi	Other region
2009	26	0.31%	Pymont	Sydney
2404	23	4.00%	Gineroi	Our Region
2340	19	2.46%	Hallsville	Our Region
2402	18	1.54%	Warialda	Our Region
2038	15	0.92%	Annandale	Sydney
4059	14	0.92%	Red hill	Brisbane
2400	12	1.85%	Moree	Our Region
4070	10	0.92%	Moggill	Brisbane



Over 67% of the ticket purchasers were new to the database and had not previously purchased tickets.

### Sales via region

	TICKET SALES	Our Region	Other Region	Interstate	Global
TOTAL 2016	1080	658	233	177	5
% Total Sales 2016	100%	61%	22%	16%	>1%
TOTAL 2017	844	590	154	100	
% Sales 2017	100%	70%	18%	12%	

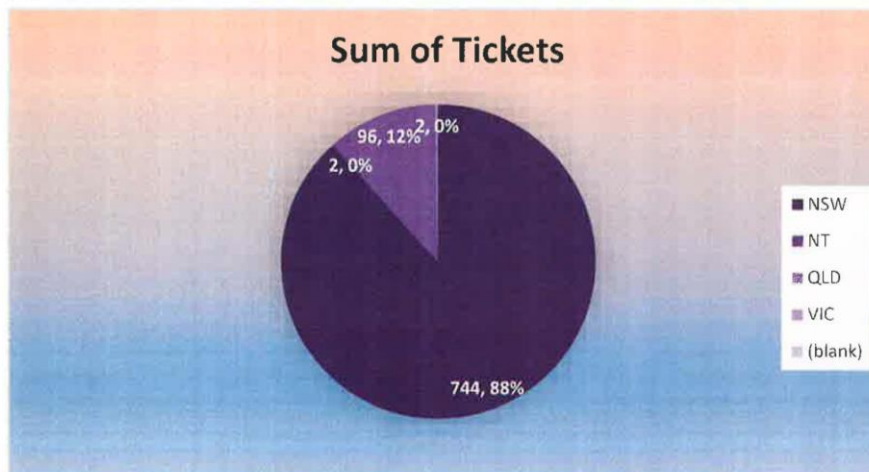
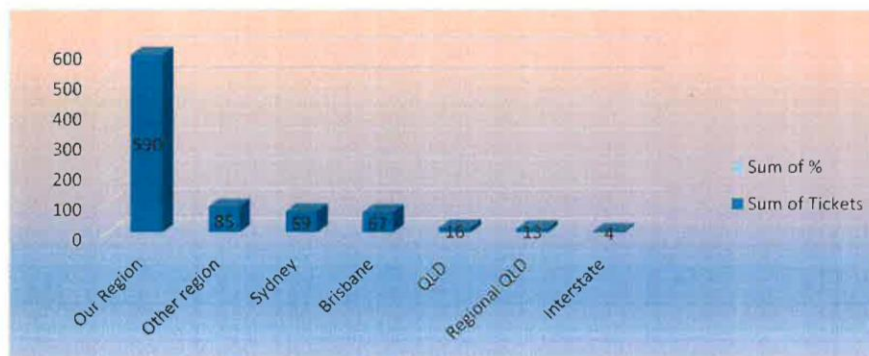

STATE	#Tix	%
NSW	744	89.54%
NT	2	0.31%
QLD	96	9.85%
VIC	2	0.31%



### Armidale - Trend by Week

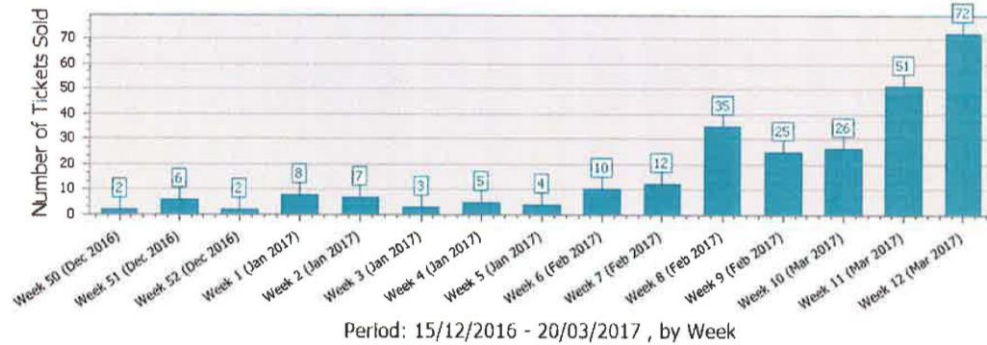

### Armidale - Sales via Type

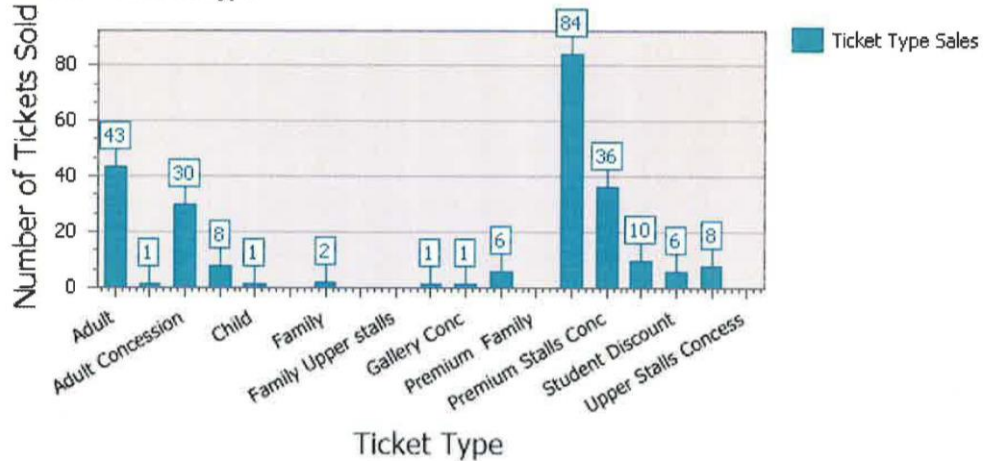

### Mimosa - Trend by Week

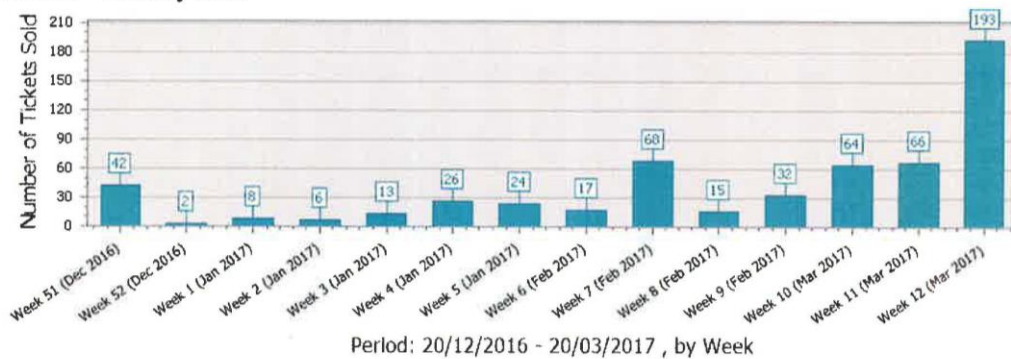

### Mimosa - Sales via Type

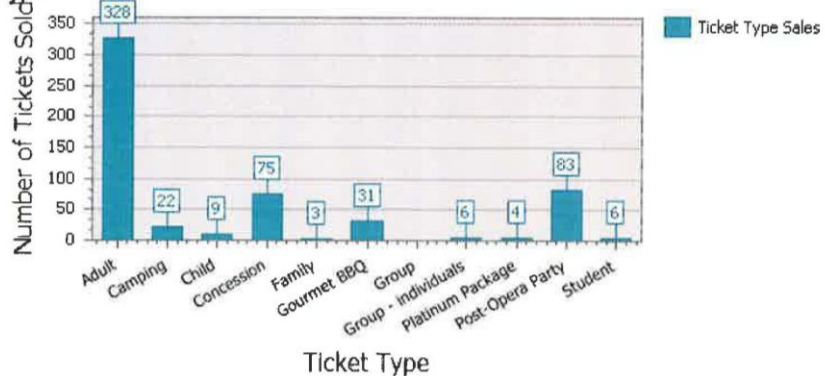

Friday March 03, 2017 INVERELL TIMES 3

## NEWS

# A family bringing opera to region

BY RACHEL BAXTER

TOP singers from across the region are set to descend on Delungra this month for Opera in the Paddock.

Delungra couple and Opera North West founders Peta and Bill Blyth have helped organise the event which has been a magnet to opera lovers for the past 14 years.

A family affair – Ms Blyth sang opera internationally before trading the stage for family and the Blyths' Delungra farm, which has been owned by Mr Blyth's family for 107 years.

This year Opera in the Paddock has formed alliances with the University of New England and Armidale Regional Council to spread the benefits of the event for the region.

Ms Blyth said the partnerships would make an important contribution to the quality and future of the event.

"Knowing that we have some of the costs covered allows us to concentrate on making the event run to its highest potential," she said.

"Support from UNE and ARC is vital to the project.

"They will get to see a performance that would cost at least twice as much if they went to see it in a capital city."

Ms Blyth said each year the event brings people together.

"Every year, after the exhaustion has worn off, I remember what fun it was

Knowing that we have some of the costs covered allows us to concentrate on making the event run to its highest potential.

Peta Blyth

to bring people together for music and song, and what fun it is to give people such enjoyment in your house paddock. And off we go again," she said.

ARC administrator Dr Ian Tilley observed that the event drew a big crowd from ARC's region, and not all of them were in the audience.

"Opera in the Paddock provides a rare opportunity for our local musicians to work in a world-class musical environment," he said.

"And to remind the region that we have some world-class musicians working and teaching in our midst."

The 2017 version, which is also the event's fourteenth showing, will be held at two venues including at UNE's Lazenby Hall on March 24 and "under the stars" at the Delungra farm "Mimosa" on March 25.

inverelltimes.com.au



MOZART DUET: Jeremy Kleeman and Eleanor Greenwood.



FROM THE START: Soprano and Opera in the Paddock founder Peta Blyth.



RISING STAR: Soprano Panayiota Kalatzis made her Delungra debut.

## Paddock song under the stars

THE ground underfoot was dry, the stars pulsed and the music swept across the bowl of Mimosa like a chamois cloth. Opera in the Paddock enjoyed perfect conditions on Saturday night for its Delungra concert at the property where the event was born in 2002. Opera

North West artistic director Peta Blyth said they were very pleased with the results.

"It was a wonderful night – so lucky with the weather; it was perfect," she said. This year the event featured three younger performers, up-and-coming in the industry. Peta said they valued the

event. "They did – a fantastic time and it's a different experience, because singing in the outdoors is quite different, and they would have gained a lot from that," she said.

Find a slideshow and audio of the night with the online version of this article.

### CONTACTS

4 INVERELL TIMES Friday March 12, 2017

## NEWS

# Baritone preps for the paddock

YOUNG bass baritone Jeremy Kleeman will make his first Opera in the Paddock next week. He took a little time to talk about next week's events.

**What are you most looking forward to about performing at Opera in the Paddock?**

I am really happy that how we have put together the program for Opera in the Paddock; it is a wonderful mix of opera, operetta, and classic songs, and I can't wait to sing it all with orchestra. I am also looking forward to teaming up with Tim Sexton again having really enjoyed working with him on Cloudstreet in Adelaide last year, and finally, Armidale is where my mum was born and where my grandparents lived and worked for a time, so it is always meaningful for me to come and sing in the area.

**Do you think there are any differences between rural and metropolitan audiences?**

Certainly not when it comes to opera knowledge. I regularly come across big opera fans in the country. Perhaps if anything, a greater appreciation for each performance as there aren't generally as many.

**What has been the highlight of your career to date?**

Being part of the creation of two new Australian operas last year, Cloudstreet, and

Voyage to the Moon, the latter also being my first professional lead, my first national tour, and my first individual Helpmann Award and Green Room Award nomination.

**Last year, tenor Brad Daley swallowed a fly while in full flight on stage. Can you tell us about something interesting/funny/quirky that might have happened to you?**

Well I have also swallowed a fly while practicing my breathing while riding my bike. But on stage, what comes to mind from when I sang Figaro on tour last year. In one show somebody in the audience's phone was ringing every 10 minutes. Normally, I would just let it go and assume that it was a once off, but on the fourth occasion I just had to say something. Luckily we were in a dialogue scene at the time, so when Susanna asked what my plan was I replied, "I will tell you in one moment just after this person switches off their phone!". It is always a risk to ad lib, but on this occasion it was well received and we were able to get on with the show! I do feel sorry for the owner of the phone in question though, one of my biggest fears as an audience member is my own phone going off!

For times and ticket information, go to <http://www.operainthepaddock.com.au>.



**TALENT:** Jeremy as Magus in Voyage to the Moon with Musica Viva and Victorian Opera. Photo: Jeff Busby



Jeremy Kleeman as Toby Raven in Cloudstreet (centre) with Desiree Frahn and Nicholas Jones. Photo: Oliver Toth





## OPERA IN THE PADDOCK

### ARMIDALE + "MIMOSA" DELUNGRA 2017

Opera North West is delighted to announce two performances of *Opera in the Paddock* for 2017: the first in Armidale on Friday 24th March and the second on Saturday 25th March under the stars at "Mimosa" Delungra.

Commencing in 2002, *Opera in the Paddock* has become synonymous with an event of unparalleled quality in regional NSW.

The 2017 performances includes a stellar line-up of young, emerging, talented performers including mezzo soprano Eleanor Greenwood, soprano Panayiota Kalatzis and bass baritone Jeremy Kleeman who will join familiar paddock favourites tenor David Hamilton and soprano Peta Blyth.

Opera North West welcomes back Timothy Sexton, Artistic Director of State Opera of South Australia, to conduct the Mimosa Orchestra. Together with the twenty-two piece Mimosa Orchestra, the singers will present a stunning selection of opera, operetta a much-loved classic musicals.

Also exciting is the addition of a choir of regional singers, including members of the Willoughby Singers, Sydney and a special guest appearance of the young singers of NECOM's Cantilena Chorale for the Armidale performance.

Whether you choose the convenience of Lazenby Hall, or the magical experience under the stars in the paddock at "Mimosa" Delungra, don't miss this unforgettable event.

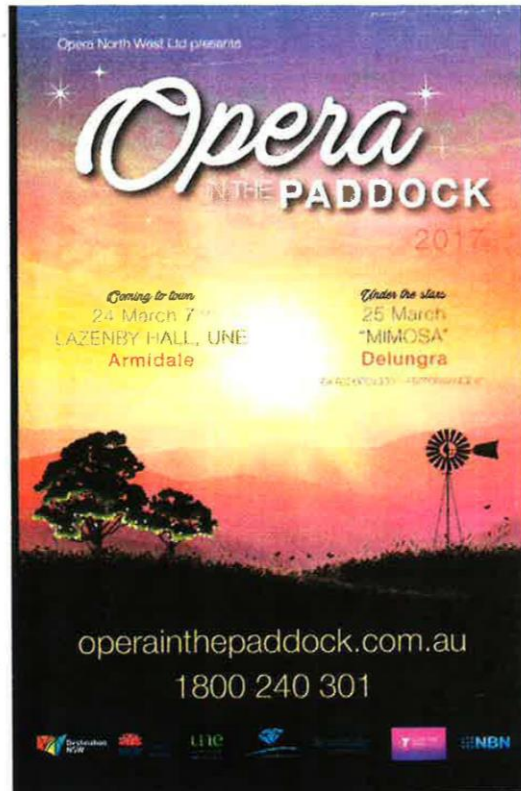

FOCUS, JAN + FEB 2017

NRMA JAN/FEB, 2017

OPEN ROAD

YOUR LOCAL GUIDE TO YOUR REGION

## Opera in the Paddock

Enjoy a unique experience with your friends and family when Australia's brightest stars come to the New England region to perform opera classics from Mozart, Verdi, Puccini and Offenbach, along with musical favourites by Lerner and Loewe and many more.

Come early and have a picnic in the beautiful bush surrounds or choose from the range of catering and package options. This year tickets start from just \$30 for

children 8+, with a range of prices for adults, concession holders and groups. Bush camping is available at the 'Mimosa' performance.

Two performances only: Friday 24 March, 7pm Lazenby Hall, UNE, Armidale or UNDER THE STARS Saturday 25 March "Mimosa" Delungra (west of Inverell). Gates open at 3.30pm and performances start at 6pm.

For more details please visit [operainthepaddock.com.au](http://operainthepaddock.com.au).

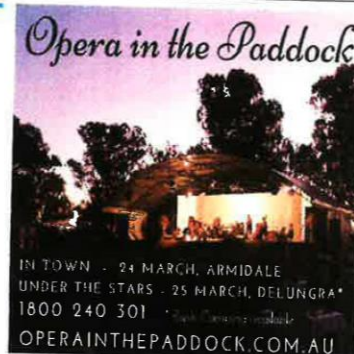
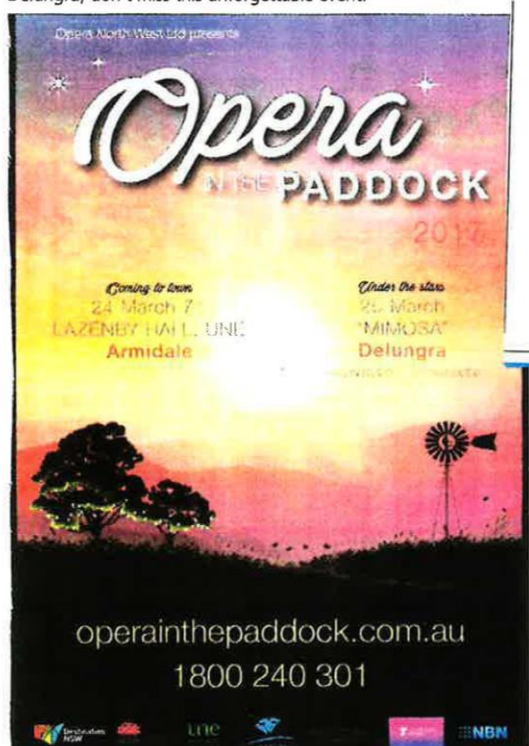

FOCUS  
JAN/FEB 2017

armidaleexpress.com.au

Wednesday March 08, 2017 ARMIDALE EXPRESS EXTRA 3

## Opera in the Paddock is coming to town to perform classics



Peta Blyth performing in Opera in the Paddock at Lazenby Hall last year.



Peta Blyth performing with Elizabeth Campbell and Annabelle Chaffey.



Peta Blyth with Hakan Hagegard in the Magic Flute in 1986.

OPERA in the Paddock has developed a reputation for delivering some of the highest quality musical performances in regional NSW.

And this year, they are giving two concerts.

The performers are "coming to town" in Armidale for their second year at Lazenby Hall on March 24 from 7pm.

And on March 25, an "under the stars" performance will begin at 7pm on the Blyth's Delugra farm Mimosa.

The program includes works by Mozart (Don Giovanni, Idomeneo, Così Fan Tutti), Bellini (Beatrice di Tenda), Donizetti (L'elisir d'amore), Verdi (Brani), Wagner (Die Walküre), Bizet (Carmen), Kalman (Countess Maritza), Offenbach (La Grande Duchesse de Gerolstein), as well as lighter classics by Lehár, Johann Strauss Jr and Cole Porter among others.

Students may receive a \$20 discount.

For more information on the either of their concerts or to order tickets, visit the Opera in the Paddock website at <http://operainthepaddock.com.au> or call them on 1800 240 301.

## Bush opera's humble origin

FROM an old family farm cottage near the sleepy town of Delugra, soprano Peta Blyth's voice echoed across the plains.

After a long day of renovating her husband Bill's family homestead, singing on the balcony was a great way for the opera singer to unwind.

It was a far cry from London's Royal College of Music where Peta studied her craft.

But the acoustics and ambience of her open-air practice sessions sowed the seeds for what would become one

of regional NSW's premier cultural events.

"It just resounds the sound," Peta said.

"The acoustics were so good, it was just perfect for a concert."

The pair agreed to finish their home renovations, then they approached the Inverell Shire Council for help.

"We got this tiny stage from the Inverell council," she said.

"I thought we'd get 100 people and that would be it."

And so Opera in the Pad-

66

Even the name Opera in the Paddock - my son Simon said 'you can't call it that mum' - but I was right.

Opera in the Paddock founder Peter Blyth OAM

dock was born.

"It took me a bit to pluck up the courage to do it actually," Peta said.

"It was just so different.

"Even the name Opera in

the Paddock - my son Simon said 'you can't call it that mum' - but I was right.

"It's that juxtaposition of opera and paddock - and it works.

Almost 15 years on, the show has a 22-piece orchestra, a permanent stage on the Blyth's property, and is also performing in Armidale's Lazenby Hall.

"People are still afraid of that opera word," Peta said. "But what we do is different."

"Last year, the tenor swallowed a fly."

Peta also said the reason for ruining the show had changed.

"At the start, it was important to me because of what

I had done in the past," Peta said.

"But I think it's a bit different now."

"I'm stepping back a little bit and trying to showcase some younger people because I think it's important to help new talent perform."

"It's less about me."

This year, the concerts will have about 12 performers from the region and the New England Conservatorium of Music's Castles Chorus will also accompany the soloists.

ARMIDALE EXPRESS EXTRA



focus new england focus

# OPERA

IN THE  
PADDOCK

Renowned conductor Timothy Sexton is set to take up the baton once again for the forthcoming major regional event Opera in the Paddock. The program promises to be both stimulating and exhilarating. It is the participation of these leading professionals that has cemented the event's reputation as a world-class event. This year, two performances will take - the first in Lazenby Hall, UNE on Friday 24th March and the second in the paddock at 'Mimosa' Delunga on Saturday 25th March 2017.

**TIMOTHY SEXTON**  
CEO AND ARTISTIC DIRECTOR,  
STATE OPERA OF SOUTH AUSTRALIA

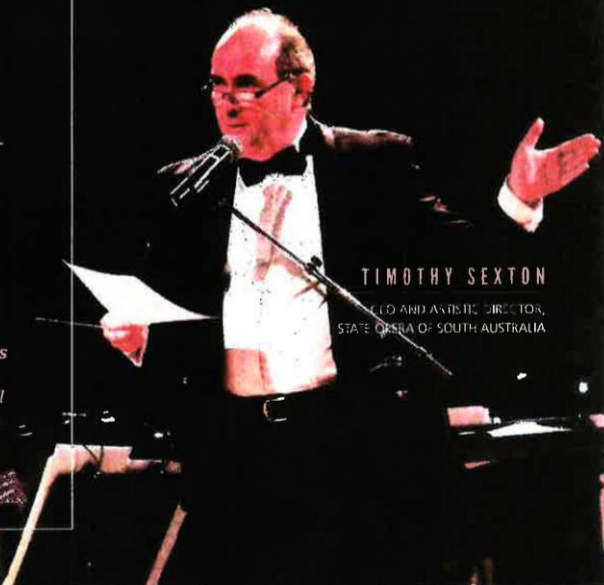

**Y**ou conducted your first Opera in the Paddock in 2009. This year will be the 6th time that you take up the baton. What is it about the event that keeps you

coming back?

I really enjoy the opportunity to do things differently and to take part in events which communicate in a special way with audiences. Opera in the Paddock does that magnificently. I also love the chance to make great music with colleagues and share that with appreciative audiences. It takes music out to people in a very memorable way.

As the CEO and Artistic Director of the State Opera of South Australia, you are based in Adelaide which is bursting at the seams with cultural activity. How important is it that events like Opera in the Paddock take place in rural Australia?

Everybody has the right to be able to access high quality cultural events. Access to culture is a birthright, no matter where you live. What we do with Opera in the Paddock is not elitist, but elite, in exactly the same way that we refer to athletes as being elite - i.e. artists at the top of their game. What better way to find the new June Bronhill (born in Broken Hill) or the new David Hobson (born in Ballarat) than to be out and amongst them, sharing that experience? What sets rural and metropolitan audiences apart?

Rural audiences tend to be much less reserved, and are far quicker to express their pleasure (and perhaps their occasional

displeasure) than city audiences. That's one of the things that makes it exciting - a rural performance becomes a type of unspoken dialogue between the stage and the audience, as you can immediately feel the audience's mood and vibe. At times, it can be absolutely electric.

What do you enjoy most about spending time in the bush during Opera in the Paddock?

I was born in country South Australia and all my Australian ancestors were rurally based (farmers, railway station masters). Although my work is based in the city, I have lived in rural South Australia now for the last 32 years. For me, being in the bush is always like coming home. It's not just about the environment, but about the people. Country people understand the concept of community. They live it every day, but it's a way of thinking that city-based people can't really comprehend. That sense of community is precious and something of which the whole world is desperately in need at the moment. cont.

You have a passion for astronomy, including building your own telescope from scratch at the age of twelve, as well as having your own observatory at home. What is it like performing at Opera in the Paddock under the stars?

A bit distracting. I want to be looking up! But I jest. The stars add that extra sense of space and magic to a performance, especially on a very still night. It reinforces the notion that although we, as a species, may be insignificant on a universal scale, we can produce something

that is sublime and beautiful and which compliments the majestic band of the Milky Way above.

As well as directing the State Opera of SA, you are also a prolific composer of more than 200 works, ranging from opera, to children's theatre to choral works and film music. How do you find the time and where does your inspiration come from?

Finding time is very difficult, especially with the demands of the opera company. So I've been somewhat less prolific since stepping into that role, but inspiration has a way of cutting through. Inspiration can come from anywhere and at any time. For me, compositions need time to gestate, so trying to snatch a clear hour or two here or there doesn't work. You need to have dedicated clear time (two or three days in a row) for the ideas to form and mature and to have time to notate them properly.

Your achievements in music have been highly recognised, including receiving the SA Great South Australian of the Year in the Arts, as well as a Centenary Medal for Services to Music. Is there anything you feel that you would still like to accomplish?

I was very humbled in 2016 to receive a Distinguished Alumni Award from the University of Adelaide. That was very special. While a Helpmann Award would be nice to win, I've

*"It's the feeling of camaraderie and achievement you have with your peers when everything goes to plan and the whole work you create is greater than the sum of its parts."*

been nominated twice), awards are not why I do what I do. Recognition is great but the greatest satisfaction comes from creating something special. It's the feeling of camaraderie and achievement you have with your peers when everything goes to plan and the whole work you create is greater than the sum of its parts. That's when magic happens, and no award can begin to replicate the euphoria of magic.

Incidents such as a tenor swallowing a fly mid-performance have occurred at Opera in the Paddock in the past. Fortunately, the episode was superbly handled with a touch of burlesque, much to the amusement of the audience. Do you have a memorable moment that stands out for you?

Well that's probably the standout funny moment for me at Opera in the Paddock. I was there for that one and that was both special and downright hilarious! I think that's the same concert when the soloists in the second half came out in footy shorts and gum boots. The things I recall most clearly though are the moments when that magic occurs and there is no barrier between the stage and the audience. It is at those moments that time stands still.

Bookings and enquires: [www.operainthepaddock.com.au](http://www.operainthepaddock.com.au) or tel: 1800 240 301

**TO ECONOMIC & COMMUNITY SUSTAINABILITY COMMITTEE MEETING 14/6/2017**

<b>ITEM NO:</b>	1.	<b>FILE NO:</b> S12.5.1
<b>DESTINATION 5:</b>	The communities are served by sustainable services and infrastructure	<b>S</b>
<b>SUBJECT:</b>	<b>BUDGET AND OPERATIONAL PLAN REVIEW 2016/2017</b>	
<b>PREPARED BY:</b>	Ken Beddie, Director Corporate & Economic Services	

**SUMMARY:**

Each quarter, Council is required to report on its Operational Plan. Council's Responsible Accounting Officer is also required to report whether they believe that the Budget Review Statement indicates that the financial position of the Council is satisfactory, having regard to the original estimate of income and expenditure, and if unsatisfactory, make recommendations for remedial action. It is required that the Committee adopt the report.

**COMMENTARY:****2016/2017 BUDGET VARIATIONS:**

It is advised that Council's financial position remains sound.

As a result of changes since the last meeting, the following table represents variations required to budget votes, to ensure the 2016/2017 Budget remains in balance (Appendix 1, H10 – H11). Items identified as requiring funding since the adoption of the 2016/2017 budget, have now been funded in full.

The Budget Variations for 2016/2017 are as follows:

**COMBINED FUND - BUDGET VARIATION SUMMARY REPORT  
ESTIMATED CASH POSITION 30 JUNE, 2017  
FOR 2016/2017 ACTIVITIES**

	<b>General</b>	<b>Water</b>	<b>Sewer</b>	<b>Total</b>
<b>Adopted Budget 2016/2017</b>	6,954,006	822,464	706,869	8,483,339 Deficit
Add Back Depreciation	(6,688,450)	(823,500)	(707,000)	(8,218,950) (Non-cash)
Add Back Carry Amount Assets Sold	(286,612)	-	-	(286,612) (Non-Cash)
Internally Restricted Cash Utilised	19,500			19,500
Transferred to Internally Restricted Cash	-	-	-	-
<b>ESTIMATED CASH RESULT FOR 2016/2017 ACTIVITIES</b>	<b>(1,556)</b>	<b>(1,036)</b>	<b>(131)</b>	<b>(2,723) SURPLUS</b>
<b>2016/2017 Budget Variations Required to Maintain a Balanced Budget</b>				
<b>REVOTES</b>	10,304,319	856,426	4,301,991	15,462,736
<b>UNEXPENDED GRANTS</b>	2,413,197	-	-	2,413,197
Adjustments 30-9-16	-	-	-	-
Adjustments 31-12-16	-	-	-	-
Adjustments 31-3-17	-	-	-	-
Adjustments 26-5-17	-	-	-	-
<b>SUB TOTAL</b>	<b>12,717,516</b>	<b>856,426</b>	<b>4,301,991</b>	<b>17,875,933</b>
<b>Internally Restricted Cash Utilised</b>	-	-	-	-
<b>FUNDED FROM EQUITY</b>	<b>(12,717,516)</b>	<b>(856,426)</b>	<b>(4,301,991)</b>	<b>(17,875,933)</b>
<b>NET BUDGET VARIATIONS</b>	<b>0</b>	<b>0</b>	<b>0</b>	<b>0</b>
<b>REVISED CASH RESULT FOR 2016/2017 ACTIVITIES</b>	<b>(1,556)</b>	<b>(1,036)</b>	<b>(131)</b>	<b>(2,723) SURPLUS</b>

**DEFINITIONS:**

- 1) **REVOTES** - Revotes are works budgeted and funded in the previous Financial Year, carried forward for completion in the current financial year. Revotes only occur if cash funding remains available from that previous Financial Years Budget to fund the works. The cash is held as equity.
- 2) **FUNDED FROM EQUITY** - Represents Cash funding received in previous financial years from Revenues, Grants and Other Sources and held as Cash due to its non-expenditure, carried forward to fund the required works in the current Financial Year.
- 3) **INTERNALLY RESTRICTED CASH** - Is cash held in investments to fund future financial obligations, for

The report indicates that the Net Budget Variations for 2016/2017 continue to remain at “Zero”. This means that all budget variations required to be made to this point, to cover increased or additional expenditures, have been fully funded from either Council receiving additional income or alternately from reductions in expenditures in other areas. There has been no reduction in working capital.

**GENERAL FUND – OPERATIONAL PLAN REVIEW:**

The General Fund remains in balance with the predicted Cash Surplus in respect of 2016/2017 operations remaining unchanged following approval of the budget variations attached to this report



(Appendix 1, H10 – H11). This is after transfers to/from Internally Restricted Assets and Revotes from previous years and the bringing forward of Grant Funding received in 2015/2016, which will be expended in 2016/2017.

A range of additional costs have and are expected to be incurred in the General Fund over the year. These are to be funded as indicated in the Budget Variation Report, from cost savings in other areas and from additional income received. These do not result in a draw-down of equity in the General Fund.

A comprehensive review of the General Fund Budget indicates that overall, incomes and expenditures to 26 May, 2017 are in accordance with the adopted budget. All matters not in accordance with the adopted Budget are included in the Budget Variation Report.

Overall, the operational and financial position of the General Fund Function is sound.

#### **WATER FUND – OPERATIONAL PLAN REVIEW:**

The Water Fund continues to show sound growth. Overall, the operational and financial position of the Water Fund function is sound.

#### **SEWERAGE FUND OPERATIONAL PLAN REVIEW:**

The Sewerage Fund continues to hold a sound operational and financial position.

#### **OPERATIONAL PLAN – COMBINED FUND**

Overall Council's operational and financial position, in respect of its five destinations, is sound. The following information is provided in respect of major issues and projects that Council is leading, participating in, or delivering in 2016/2017:

- Destination 1 – A recognised leader in the broader context:
  - Participation in Road Funding meetings with the Roads and Maritime Services;
  - Participation in New England North West Regional Tourism meetings;
  - Participation in New England Destination Management Hub;
  - Participated in meetings with New England Councils Joint Organisation of Councils in the New England. Secretariat for the General Manager's Group;
  - Participated in Border Region Organisation of Councils Meeting;
  - Seeking grants for the benefit of the community;
  - Cinema Under the Stars series for Shire villages; and
  - Implementing White Ribbon Australia workplace accreditation.
- Destination 2 – A community that is healthy, educated and sustained:
  - Facilitation role for "Linking Together Centre" and development of strong partnerships with Best Employment, State and Federal Government funding bodies;
  - Assist with Sapphire City Festival;
  - Assist with Grafton to Inverell cycle race;
  - Partnering with Family NSW to provide Playgroup activities at Tingha and Inverell;
  - Participation in New England Cooperative Library;
  - Working with BEST Employment in respect of the auspicing of Connections Disability Service;
  - Commenced Yetman Hall Upgrade;
  - Facilitate the Big Bike Ride to support NSW Bike Week;
  - Drafted Inclusion Action Plan;
  - Drafted Crime Prevention Plan; and
  - Hosted two International Women's Day functions with 180 participants.

- Destination 3 – An environment that is protected and sustained:
  - Partnering with Local Land Services' Brigalow Nandewar Biolinks Program;
  - Riverbank clean-up adjacent to Campbell Park;
  - Completed grant funded landscaping and installation of hybrid solar-wind lighting at Waratah Park;
  - Installed Solar/Wind Turbine Lighting in Lions Park and along Old Bundarra Road;
  - Weed control on Dumaresq River;
  - Invasive species removal of river weeds in Inverell;
  - Remove Harrisia Cactus at Yetman;
  - Partnered with Inverell RSM Fishing Club in Gone Fishing Day event;
  - Installed solar lighting along Captain Cook Drive cycleway;
  - Heritage grants awarded to seven recipients.
- Destination 4 – A strong Local Economy:
  - Participated in a wide range of tourism and marketing events;
  - Participated in Inverell promotional activities with the Inverell Chamber of Commerce and Industry;
  - Ongoing discussions with Bindaree Beef in respect of their major expansion;
  - Commence "Retail Revamp" program for small business;
  - Participate in Eat Drink Live New England; and
  - Delivered 4 Small Business Workshops with 71 participating business.
- Destination 5 – The Communities are served by sustainable services and infrastructure:
  - Commenced and completed a range of Road Upgrade Projects on the Regional and Local Road Network;
  - Completed a significant quantum of Shire Roads Gravel Resheeting;
  - Completed a significant quantum of heavy patching throughout the Shire;
  - Completed Council's 2016/2017 bitumen reseal program;
  - Completed 2015/2016 financial statements – sound financial result achieved, with no audit issues raised;
  - Commenced upgrade works at Inverell Sports Complex;
  - Completed installation of new playground equipment in Lions Park;
  - Completed infrastructure works at Bellevue Park;
  - Completed 2016/2017 footpath programs – Roslyn Street and Lake Inverell;
  - Called Tenders for Tin Tot Bridge replacement and the upgrade works at the Inverell Sewerage Treatment Plant;
  - Completed installation of new shelters at Waratah Park (grant funded);
  - Completed new Ashford Sportsground amenities block;
  - Completed public art installation in Henderson Street Roundabout;
  - Install outdoor gym at Yetman Recreation Ground; and
  - Village grants awards to ten community groups.

#### **RELATIONSHIP TO STRATEGIC PLAN, DELIVERY PLAN AND MANAGEMENT PLAN:**

**Strategy:** S.01 Sound Local Government Administration, Governance and Financial Management are provided.

**Operational Objective:** CS.04 Financial Services – To manage Council Finances with the view to ensuring Council's ongoing financial health and stability, the discharge of statutory and fiduciary responsibilities, proper accounting systems and standards and an efficient and equitable revenue base.

#### **POLICY IMPLICATIONS:**

No Council or Management Policy is relevant at this time, however, adoption of the recommendation will ensure that Council's philosophy of maintaining balanced budgets continues.

**CHIEF FINANCIAL OFFICER'S COMMENT:**

In accordance with the *Local Government (General) Regulation 2005*, it is my opinion that the Quarterly Budget Review Statement for Inverell Shire Council for the quarter ended 26 May, 2017 indicates that Council's projected financial position at 30 June, 2017 will be satisfactory at year end, having regard to the projected estimates of income and expenditure and the original budgeted income and expenditure.

Adoption of the proposed budget variations as indicated above will maintain Council's 2016/2017 Budget in balance, with an indicative surplus of \$2,723.

**LEGAL IMPLICATIONS:**

Council is required to comply with the provisions of the *Local Government Act, 1993* and *Local Government Regulation, 2005* in these matters.

**RECOMMENDATION:**

*That the Committee recommend to Council that:*

- i) the proposed variations to budget votes for the 2016/2017 Financial Year be adopted providing an estimated cash surplus at 30 June, 2017 from operations of \$2,723.*

<b>ITEM NO:</b>	2.	<b>FILE NO:</b> S12.12.2/09
<b>DESTINATION 5:</b>	The communities are served by sustainable services and infrastructure	<b>S</b>
<b>SUBJECT:</b>	<b>MONTHLY INVESTMENT REPORT</b>	
<b>PREPARED BY:</b>	Paul Pay, Manager Financial Services	

**SUMMARY:**

To report the balance of investments held as at 31 May, 2017.

**COMMENTARY:**

Contained within this report are the following items that highlight Council's Investment Portfolio performance for the month to 31 May, 2017 and an update of the investment environment:

- (a) Council's investments as at 31 May, 2017
- (b) Council Investments by Fund as at 31 May, 2017
- (c) Interest – Budgeted vs Actual.
- (d) Investment Portfolio Performance.
- (e) Investment Commentary.
- (f) Certification – Responsible Accounting Officer.

**A) Council Investments as at 31 May, 2017**

Term Deposit Investment Group										
Investment No.	Borrower	FUND	Rating	Risk Rating	Purchase Date	Maturity Date	Current Yield	Principal Value	Current value	Term (days)
17/27	National Australia Bank	General	A1+	1	02-Dec-16	02-Jun-17	2.71%	2,000,000	2,000,000	182
17/29	CBA	General	A1+	1	12-Dec-16	09-Jun-17	2.61%	1,000,000	1,000,000	179
17/21	National Australia Bank	General	A1+	1	14-Oct-16	14-Jun-17	2.72%	1,000,000	1,000,000	243
17/35	National Australia Bank	Water	A1+	1	09-Jan-17	07-Jul-17	2.66%	1,000,000	1,000,000	179
15/01	CBA	General	A1+	1	15-Jul-14	15-Jul-17	4.05%	1,000,000	1,000,000	1095
15/02	CBA	General	A1+	1	15-Jul-14	15-Jul-17	4.05%	1,000,000	1,000,000	1095
15/03	CBA	General	A1+	1	15-Jul-14	15-Jul-17	4.05%	1,000,000	1,000,000	1095
17/36	Bank West	Sewer	A1+	1	17-Jan-17	17-Jul-17	2.65%	2,000,000	2,000,000	181
17/37	St George Bank	General	A1+	1	17-Jan-17	17-Jul-17	2.70%	2,000,000	2,000,000	181
17/25	CBA	General	A1+	1	18-May-16	16-Jul-17	2.65%	1,000,000	1,000,000	210
17/23	CBA	Sewer	A1+	1	20-Oct-16	20-Jul-17	2.64%	2,000,000	2,000,000	273
15/09	CBA	General	A1+	1	01-Sep-14	01-Sep-17	3.90%	1,000,000	1,000,000	1096
17/17	National Australia Bank	Water	A1+	1	27-Sep-16	27-Sep-17	2.70%	1,000,000	1,000,000	365
17/13	CBA	General	A1+	1	17-Sep-16	17-Sep-17	3.00%	1,000,000	1,000,000	365
17/33	St George Bank	General	A1+	1	02-Jan-17	02-Oct-17	2.71%	1,000,000	1,000,000	123
17/18	St George Bank	General	A1+	1	07-Oct-16	07-Oct-17	3.00%	2,000,000	2,000,000	365
17/19	St George Bank	General	A1+	1	07-Oct-16	07-Oct-17	3.00%	2,000,000	2,000,000	365
17/44	National Australia Bank	General	A1+	1	13-Apr-17	10-Oct-17	2.57%	1,000,000	1,000,000	180
17/22	St George Bank	General	A1+	1	16-Oct-16	16-Oct-17	3.00%	1,000,000	1,000,000	183
17/05	AMP BANK	General	A1	2	30-Mar-17	27-Nov-17	2.75%	2,000,000	2,000,000	242
17/06	AMP BANK	General	A1	2	30-Mar-17	27-Nov-17	2.75%	1,000,000	1,000,000	242
17/07	AMP BANK	Water	A1	2	30-Mar-17	27-Nov-17	2.75%	1,000,000	1,000,000	242
17/08	AMP BANK	General	A1	2	30-Mar-17	27-Nov-17	2.75%	1,000,000	1,000,000	242
17/48	NAB	General	A1+	1	30-May-17	27-Nov-17	2.50%	2,000,000	2,000,000	181
17/49	Bank West	General	A1+	1	30-May-17	27-Nov-17	2.50%	2,000,000	2,000,000	181
17/50	Suncorp Bank	General	A1+	1	30-May-17	27-Nov-17	2.60%	1,000,000	1,000,000	181
17/51	Bank of Queensland	General	A1	2	30-May-17	27-Nov-17	2.65%	1,000,000	1,000,000	181
17/28	St George Bank	Water	A1+	1	01-Dec-16	01-Dec-17	2.75%	1,000,000	1,000,000	365
17/30	Suncorp	General	A1+	1	14-Dec-16	14-Dec-17	2.75%	1,000,000	1,000,000	365
17/31	National Australia Bank	General	A1+	1	14-Dec-16	14-Dec-17	2.72%	2,000,000	2,000,000	365
17/32	Community Mutual	Water	NR	3	14-Dec-16	14-Dec-17	2.90%	2,000,000	2,000,000	365
17/46	Suncorp	General	A1+	1	27-Apr-17	08-Jan-18	2.58%	1,000,000	1,000,000	256
17/47	Suncorp	General	A1+	1	27-Apr-17	08-Jan-18	2.36%	1,000,000	1,000,000	256
17/34	National Australia Bank	General	A1+	1	09-Jan-17	09-Jan-18	2.70%	1,000,000	1,000,000	365
17/39	National Australia Bank	General	A1+	1	15-Mar-17	15-Mar-18	2.63%	2,000,000	2,000,000	365
17/45	CBA	General	A1+	1	18-Apr-17	18-Apr-18	2.64%	1,000,000	1,000,000	365
15/10	Bank of Queensland	General	A1	2	02-Sep-14	03-Sep-18	4.10%	1,000,000	1,000,000	1462
Sub Total - Term Deposit Investment Group								TOTALS	49,000,000	49,000,000

Cash Deposits Accounts Investment Group										
As at Date	Borrower	FUND	Rating	Risk Rating	Purchase Date	Maturity Date	Current Yield	Principal Value	Current value	
31/5/17	National Australia Bank (Cash Maximiser)	General	A1+	1			1.50%	3,000,000	3,000,000	
Sub Total - Cash Deposits Accounts Investment Group								3,000,000	3,000,000	
Floating Rate Notes Investment Group										
As at Date	Borrower	FUND	Rating	Risk Rating	Purchase Date	Maturity Date	Current Yield	Principal Value	Current value	
Sub Total - Floating Rate Notes Investment Group							-	-		
Structured Products Investment Group										
As at Date	Borrower	FUND	Rating	Risk Rating	Purchase Date	Maturity Date	Current Yield	Principal Value	Written Down Value 30-6-15	Current value
31/12/16	Lehman Brothers Treasury Co B.V (CPPI-745)	Water	DD	5		9/5/2010*	0.00%	300,000	9,810	9,810
Sub Total - Structured Products Investment Group							-	300,000	9,810	9,810

The written down value of the Structured Product Investment Group as at 30 June, 2016 was \$9,810, now holding at \$9,810. As previously advised, the write down in the value of Structured Products, has been funded from previous years above benchmark investment returns (\$6.8M), which had been held in Internal Restricted Assets. That said, while the written down value is only \$9,810, Council has to date received \$125,423 in principal repayments. These payments are ongoing. These investments were all rated AA- and up to AAA (strong investment grade) when they were entered into and were permissible under the Minister's Investment Order. As noted by the Auditor in their 2014/2015 Audit Report, the Sewer Fund maintains a sound financial position to meet its operational requirements and the Water Fund maintains a strong financial position.

**B) Council Investments by Fund 31 May, 2017**

Portfolio by Fund	30/04/2017	31/05/2017
General Fund	38,000,000	42,000,000
Water Fund	6,009,810	6,009,810
Sewer Fund	6,000,000	4,000,000
<b>TOTAL</b>	<b>\$ 50,009,810.00</b>	<b>\$ 52,009,810.00</b>

Council investment portfolio has increased by \$2,000,000 throughout May 2017. This was in respect of normal cash flow movements for receipts collected and payments made during May 2017.

While the level of investments has been largely maintained over recent years, these will decrease during 2016/2017 as a number of major projects are completed. These include:

- Inverell Sewerage Treatment Works \$ 3.0 M
- Infrastructure Backlog Program \$ 4.01M
- Waste Infrastructure Program \$ 2.0M
- 2015/2016 Revotes \$15.5M

In addition to these amounts, Council also holds substantial unexpended grant funds in the General Fund which can only be utilised for the purpose for which they were granted.

**C) Interest – Budgeted verses Actual Result to Date**

	Ledger	2016/2017 Budget	Actuals to Date
General Fund	128820	879,000.00	724,327.34
Water Fund	812350	50,000.00	78,926.86
Sewer Fund	906320	70,000.00	96,554.54
<b>TOTAL</b>		<b>\$ 999,000.00</b>	<b>\$ 899,808.74</b>

The interest received to date (cash basis) is in accordance with Budget and does not include accruals. It is again expected that Council's Investment Portfolio will achieve benchmark returns in 2016/2017.

**D) Investment Portfolio Performance**

Investment Portfolio Return		Benchmarks		
	% pa	RBA Cash Rate	Aus Bond Bank Bill	11am Cash Rate
Benchmark as at 31-5-2017		1.50%	1.84%	1.56%
Term Deposits	2.89%			
Cash Deposit Accounts	1.50%			
Floating Rate Notes				
Structured Products*	0.00%			

\*Structured Products exclude 1 CDO's currently in default and returning zero coupon

**E) Investment Commentary**

Council's investment portfolio returns exceeded the 11am Cash Rate benchmark in all investment categories except for Structured Products and Cash Deposits Accounts. Term Deposits exceed the UBSA Bank Bill Index benchmark. Money is held in cash deposits accounts for liquidity purposes.

Council's investment portfolio of \$52M is almost entirely invested in fixed term deposits. Overall, the portfolio is highly liquid, highly rated and short-dated from a counterparty perspective.

The Reserve Bank (RBA) left the cash rate unchanged at 1.50 per cent during its May 2017 meeting. This decision was as anticipated by most economists. RBA Governor mentioned that the improvement in the global economy has contributed to higher commodity prices, which are providing a significant boost to Australia's national income. Growth in the national economy is expected to increase over the next two years to about 3 per cent.

The rise in underlying inflation in the first quarter has reduced the need to cut interest rates further, especially when lower rates would boost the still hot housing market. However, continued high unemployment, low wage growth and low underlying inflation combined with a high Australian dollar means that interest rates are unlikely to increase in the near future.

Council staff will continue to monitor interest movements to ensure the best possible returns on investments.

#### **F) Certification – Responsible Accounting Officer**

I Ken Beddie, hereby certify that the investments listed in this report have been made in accordance with Section 625 of the *Local Government Act 1993*, Clause 212 of the Local Government (General) Regulations 2005 and Council's Investment Policy.

#### **RELATIONSHIP TO STRATEGIC PLAN, DELIVERY PLAN AND MANAGEMENT PLAN:**

**Strategy:** S.01 Sound Local Government Administration, Governance and Financial Management are provided.

**Term Achievement:** S.01.02 A sound long term financial position is maintained.

**Operational Objective:** S.01.02.01 To manage Council finances with the view to ensuring Council's ongoing financial health and stability, the discharge of statutory and fiduciary responsibilities, proper accounting systems and standards and an efficient and equitable revenue base.

#### **POLICY IMPLICATIONS:**

Nil.

#### **CHIEF FINANCIAL OFFICER'S COMMENT:**

It is noted that the volatility for current financial markets and pending legal actions will not impact on Council's Rates and Charges, its ability to deliver its existing services across the funds, or its medium or long term sustainability. Council's overall Investment Portfolio remains sounds.

#### **LEGAL IMPLICATIONS:**

Nil.

#### **RECOMMENDATION:**

*That:*

- i) the report indicating Council's Fund Management position be received and noted; and*
- ii) the Certification of the Responsible Accounting Officer be noted.*

## APPENDIX 1

BUDGET VARIATIONS - FINANCE MEETING 14-6-2017		
DESCRIPTION	AMOUNT \$	COMMENT/REASON
GENERAL FUND		
<b><i>Increase/Decrease in INCOME</i></b>		
Grant-Department Prime Minister & Cabinet	5,000	Reconciliation Week 2017 Grant
Grant - Community Building Partnership Prog	20,343	Yetman Hall Upgrade
International Women's Day Income	400	Income Received
Caravan Park - sundry Income	6,420	Additional income received
Income Other Land & Buildings	4,850	Additional income received
Interest On Rates Sec 158	6,860	Additional income received
<b>TOTAL INCREASE IN INCOME</b>	<b>43,873</b>	<i>Positive figure indicates increased income,(Negative) figure indicates decreased income)</i>
<b><i>Increase/Decrease in EXPENDITURE</i></b>		
National Reconciliation Week 2017	5,000	Reconciliation Week 2017 Grant
Town/Village Halls-Improvement	40,686	Upgrades to Yetman Hall - flooring and Painting
Community Building Partnership Program	(20,343)	Part funding for above
Town Planning Travelling	3,000	Additional costs incurred
Building Travelling Expenses	(3,000)	Funding for above
Inverell Baths/Swimming Pool	6,420	New Pool Cleaner
International Women's Day Expenses	1,135	Public Event
Multicultural Day Expenses	1,210	Public Event
134330 - Community Activities	(1,945)	Funding for above
Members Travel & Subsistence	2,810	Additional costs incurred
Mayor's Travelling	(2,810)	Funding for above
Other Land & Buildings	4,850	Repair water leaks
Council Chambers Exterior & Grounds Mtc	6,860	Additional Grounds Maintenance
Yetman - Street / Gutter Cleaning	1,000	Additional costs incurred
Villages Seal Maintenance North	(1,000)	Funding for above
Passive Parks - Yetman	4,520	Additional costs incurred
Passive Park - Ashford	(2,500)	Funding for above
Passive Parks - Rest Areas North	(2,020)	Funding for above
Street Mowing	4,710	Additional costs incurred
Rural Seal Roadside Furnish	(4,710)	Funding for above
Gravel Resheeting - Minor Roads - North	3,160	Additional costs incurred
Maintenance Grading - MCE Allocation	(3,160)	Funding for above
Grading - North	11,400	Additional grading due increase rainfall
Maintenance Grading - MCE Allocation	(11,400)	Funding for above
Ashford Depot	3,810	Additional costs incurred
Roads & Traffic Signs - New	(3,810)	Funding for above
Village Seal Maint - South	1,630	Additional costs incurred
Roadside Furnishings Sth	(1,630)	Funding for above
Rural Seal Drainage	4,470	Additional costs incurred
Rural Seal Drainage North	(4,470)	Funding for above
Gravel Patching	6,370	Additional Gravel Patching due to storm damage
Maintenance Grading - MCE Allocation	(6,370)	Funding for above
Grading - South	7,490	Additional grading due increase rainfall
Maintenance Grading - MCE Allocation	(7,490)	Funding for above
Gravel Resheeting - Minor Roads	9,090	Additional Gravel Resheeting due to storm damage
Maintenance Grading - MCE Allocation	(9,090)	Funding for above
Shire Roads Sth Timber Clearing	2,050	Additional costs incurred
Shire Roads North Timber Clearing	(2,050)	Funding for above
Urban Drainage Maint	33,780	Additional drainage maintenance due to storm damage



## TO ECONOMIC &amp; COMMUNITY SUSTAINABILITY COMMITTEE MEETING 14/6/2017

Urban Drainage Reconstruction	(33,780)	Funding for above
Inverell Seal Maintenance	6,900	Additional costs incurred
Inverell Should Mtc	(6,900)	Funding for above
CBD Maintenance	24,106	Repair costs from tree damage
CBD Upgrade works	(14,135)	Funding for above
CBD Upgrade works (DCES approval required)	(9,971)	Funding for above
Works Managers - Travelling	8,000	Additional costs incurred
Road & Traffic Signs Mtc	(8,000)	Funding for above
Cycleway /Footpath - Renewals	4,534	Additional costs incurred
Specials Projects	(4,534)	Funding for above
Tree Plant & Pots Mtc	1,810	Additional expenses incurred
Horticultural - Travelling Expenses	(1,810)	Funding for above
St Cleaning Costs	33,220	Additional Street Cleaning due to storms
DCES-Special Projects	(33,220)	Funding for above
Public Privies Mtc/Working Exps	12,800	Additional CBD cleaning due to bird shit
DCES-Special Projects	(12,800)	Funding for above
Horticultural - Other Expenses	1,710	Additional expenses incurred
Horticultural - Travelling Expenses	(1,710)	Funding for above
<b>TOTAL INCREASE IN EXPENDITURE</b>	<b>43,873</b>	<i>Positive figure indicates increased expenditure, (Negative) figure decreased expenditure)</i>
<b>NET CHANGE TO CURRENT BUDGET</b>		
<b>Surplus/(Deficit)</b>	<b>-</b>	<i>Positive figure indicates increased expenditure, (Negative) figure decreased expenditure)</i>
<b>Restricted Assets</b>		
<b>TOTAL FUNDING FROM RESTRICTED ASSETS</b>	<b>-</b>	
<b>FUNDED FROM EQUITY (G5795.000)</b>	<b>-</b>	
<b>NET CHANGE TO FINANCIAL POSITION</b>		
<b>Surplus/(Deficit)</b>	<b>-</b>	
<b>WATER FUND</b>		
<b>Increase/Decrease in INCOME</b>		
Contribution to Works (Sec 64)	42,020	Additional Income Received
<b>TOTAL INCREASE IN INCOME</b>	<b>42,020</b>	<i>Positive figure indicates increased income,(Negative) figure indicates decreased income)</i>
<b>Increase/Decrease in EXPENDITURE</b>		
Staff Training	5,020	Additional costs incurred
Mains-Maints & Working Exp	37,000	Additional costs incurred
<b>TOTAL INCREASE IN EXPENDITURE</b>	<b>42,020</b>	<i>Positive figure indicates increased expenditure, (Negative) figure decreased expenditure)</i>
<b>NET CHANGE TO CURRENT BUDGET</b>		
<b>Surplus/(Deficit)</b>	<b>-</b>	<i>Positive figure indicates increased expenditure, (Negative) figure decreased expenditure)</i>
<b>SEWER FUND</b>		
<b>Increase/Decrease in INCOME</b>		
<b>TOTAL INCREASE IN INCOME</b>	<b>-</b>	<i>Positive figure indicates increased income,(Negative) figure indicates decreased income)</i>
<b>Increase/Decrease in EXPENDITURE</b>		
<b>TOTAL INCREASE IN EXPENDITURE</b>	<b>-</b>	<i>Positive figure indicates increased expenditure, (Negative) figure decreased expenditure)</i>
<b>NET CHANGE TO CURRENT BUDGET Surplus/(Def</b>	<b>-</b>	<i>Positive figure indicates increased expenditure, (Negative) figure decreased expenditure)</i>